

DESIGN & INSTALLATION GUIDE

LiteSpace Interior Aluminum Framing

Read all design guidelines and instructions before beginning installation.

Part listings and diagrams for specific LiteSpace projects are emailed to the Project Manager who places the order.

Special-Lite® makes no representations regarding the products intended application and use. It shall be the sole responsibility of the installation team to determine suitability, use, and appropriate reinforcement and/or anchors of Special-Lite LiteSpace Interior Aluminum Framing and integrated glass.

These instructions are provided to help prevent installation problems caused by most common errors. They are strictly recommendations and are not intended to be a step-by-step, foolproof installation checklist suitable for every situation. There are many variations of installations not covered in these instructions that Special-Lite assumes are general construction knowledge to an experienced installer.

WARNING: Failure to follow good practice in installation will void the warranty on Special-Lite products.

Selection of an experienced installer is the sole responsibility of the project owner or responsible party.

If you have any questions about installation techniques for your particular project, please call 1-800-821-6531 and ask for a Special-Lite Customer Service Representative. You can find these and other Installation Instructions on Special-Lite's website at special-lite.com/installation-instructions.

For visibility, we've highlighted the surfaces within the LiteSpace profiles that clips are secured to in many areas of this document.

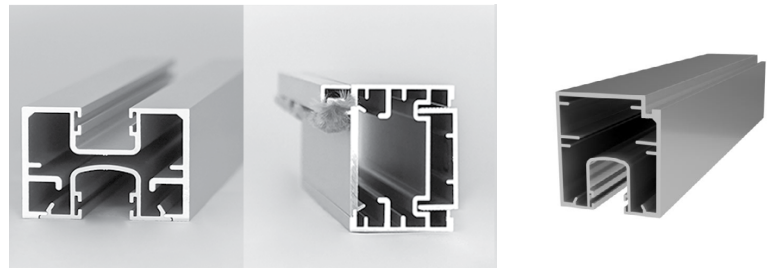

Table of Contents

Section	Page No.
Design Guidelines	3
Suggested Fasteners for Clips	6
Detail Drawing Key.....	6
Clip Identification.....	7
Installation: 3-Sided Frame	8
Installation: Swing Door with Sidelite	12
Installation: Sliding SLI Door with Sidelite	19
Miter Cut Rules for Returns	26
How to Measure for Glass and Sliding Door Sizing	27
LiteSpace Profile Names and Numbers Reference	28
LiteSpace Profile Assemblies Reference	29
Template for Sliding Glass Door Short Track.....	40
Template for Hydraulic Swing Hardware	41

Design Guidelines

Opening Requirements

- LiteSpace is designed to be mounted on finished openings.
- The opening surfaces **MUST** be level, plumb, and square.
- The opening surfaces must be clean (with no buildup of drywall or putty).
- When sliding doors are to be used, the header of the opening must be reinforced. See section titled "Slider Header Reinforcement" on Page 5.

Cut to Length

LiteSpace profile extrusions are delivered in lengths of 126" (3.20 m). These extrusions are cut to length to fit your desired opening.

Height and Weight Limitations for Standard Elevations



WARNING

Risk of serious injury or death.
Do not exceed limitations,
framing, doors, or glass may fall.

Swinging Doors

With hinge jamb mounted to finished wall:

- Maximum Opening Height: 10 feet (3.05 m)
- Maximum door height: 10 feet (3.05 m)
- Maximum total door weight, including glass and hardware: 175 lbs (79.4 kg)

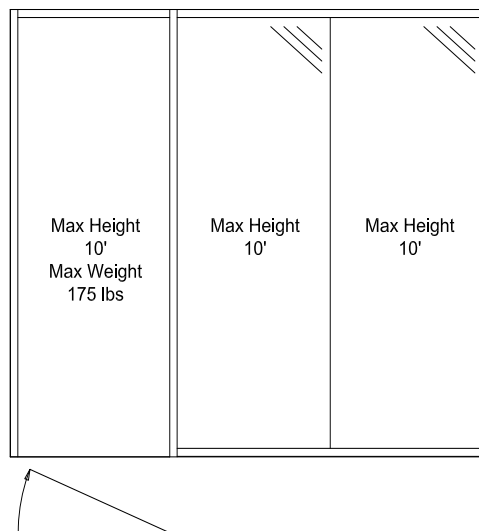

With hinge jamb mounted to vertical intermediate mullion:

- Maximum door height: 8 feet (2.44 m)
- Maximum door weight, including glass and hardware: 140 lbs (63.5 kg)

Design Guidelines (cont.)

Transom

- Glass weight should not exceed 50 lbs (22.7 kg) per section
- Should not exceed 36" (.91 meters) per section

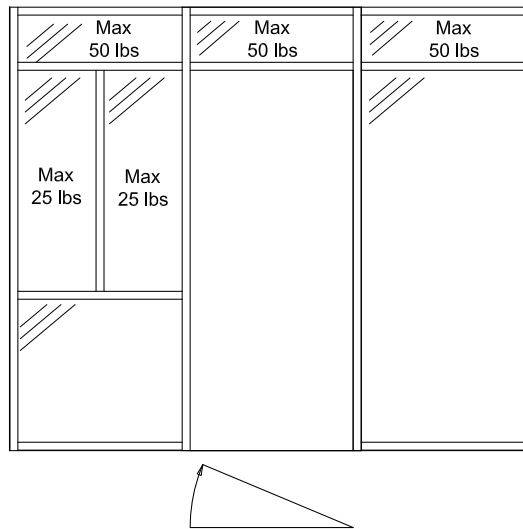

Sliding Doors

- Maximum door height: 10 feet (3.05 m)
- Maximum door weight, including glass and hardware: 264 lbs. (120 kg)
- Transoms are not permitted

Sidelite with Horizontal Mullion

- Glass weight should not exceed 50 lbs (22.7 kg) per section

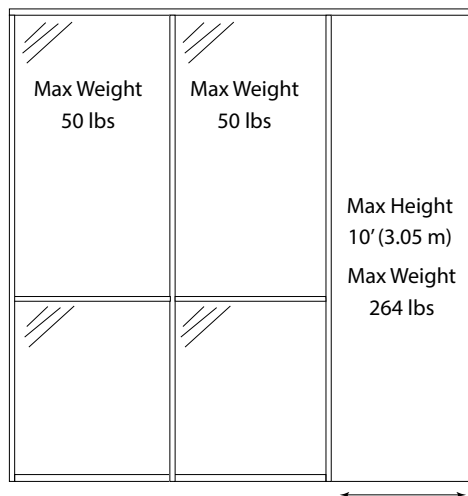

Design Guidelines (cont.)

Glazing Specifications

- LiteSpace is designed for 3/8" glass but can also accommodate 1/4" or 1/2" thick glass.
- Final measurements for ordering glass are taken after LiteSpace is installed.
- The glass is secured with a vinyl bulb, sent according to glass size specified (2 bulb sizes available).
- You **MUST** pull the vinyl glazing bulb into LiteSpace extrusions before they are installed.
- When butting glass sheets against each other, you can wet glaze or use the polycarbonate I-channel/glazing bead with glazing tape (polycarbonate is only available for 3/8" and 1/2" glass).
- When using the I-beam/glazing tape supplied by Special-Lite, the glass must be beveled and polished for a crystal clear finish. See Polycarbonate I-Channel Considerations (Page 28) for details.
- LiteSpace uses snap-in glass jamb pockets to accommodate glass installation. These pockets must be considered during the glazing stage.
 - The two sizes of glass pockets (shallow and deep) are meant to be placed opposite each other. You may also request dual deep glass pockets for wall-mounted verticals.
 - Special-Lite recommends using the deep pocket for the header. The deep pocket on the header or ceiling allows glass to be lifted up and set in bottom channel.
 - Intermediate mullions between sheets of glass require special consideration.

Header Reinforcement for Sliding Doors

The weight of a hanging, glass-laden door puts significant stress on the header of the opening. The header for a LiteSpace sliding door application **REQUIRES** reinforcement.

- Reinforce metal studs with 3/4" plywood (recommended). Please see diagram below.
- If using non-commercial grade metal studs, Special-Lite recommends wood backing for reinforcement.
- Weight of door calculations should include door leaf, glass and hardware.
- Drop ceilings require special consideration. They should be reinforced to handle loads as much as 100 lbs per square foot in the area above the opening.
- Reinforcement may include use of uni-strut to decking.



WARNING

Risk of serious injury or death. Without reinforcement, there is a high risk for falling door and glass.

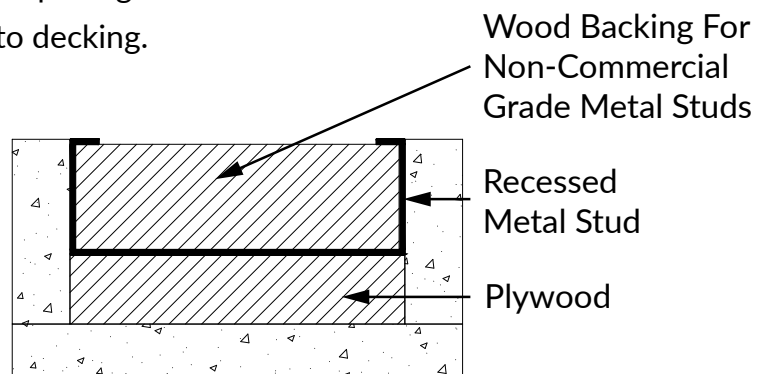

Design & Installation Guide - LiteSpace Interior Aluminum Framing

Suggested Fasteners for Clips

Special-Lite recommends the following screw types for use with LiteSpace clips. All fasteners below are available from McMaster-Carr. **Please Note:** All fasteners must be countersunk at the time of installation.

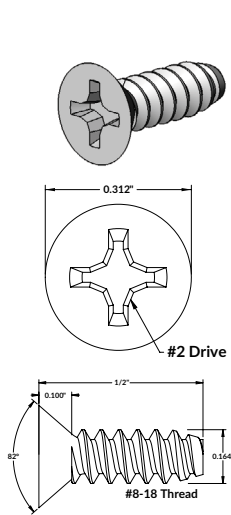

90055A294
Thread-Forming Screw
for Sheet Metal and Iron

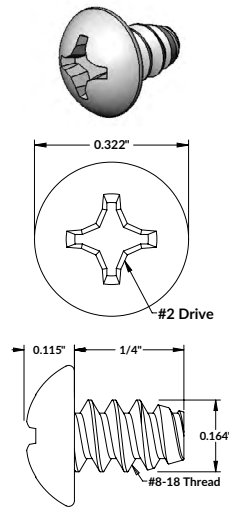

90056A190
Thread-Forming Screw
for Sheet Metal and Iron

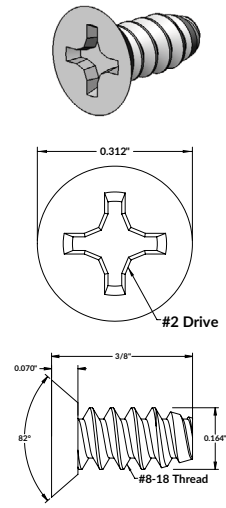

90055A192
Thread-Forming Screw
for Sheet Metal and Iron

Detail Drawing Key

The Detail Drawing numbers found in these instructions refer to configuration details of assembled LiteSpace profiles.

All numbered Detail Drawings are listed near the end of this document for reference, beginning on Page 25.

(Example: 39 refers to
SP-038, SP-040,
SP-039 and SP-028
installed together)

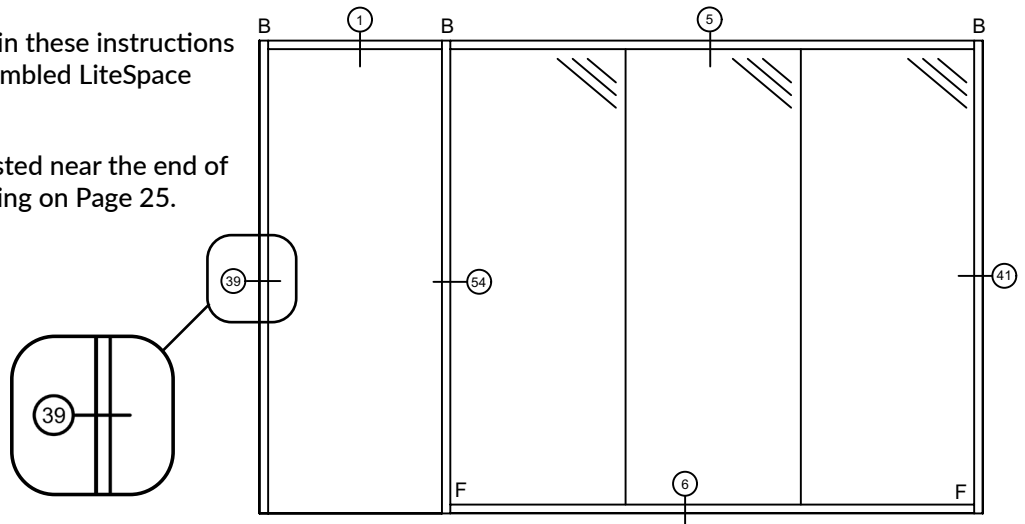

Design & Installation Guide - LiteSpace Interior Aluminum Framing

Clip Identification

B CLIP

Vertical Mullion Clip

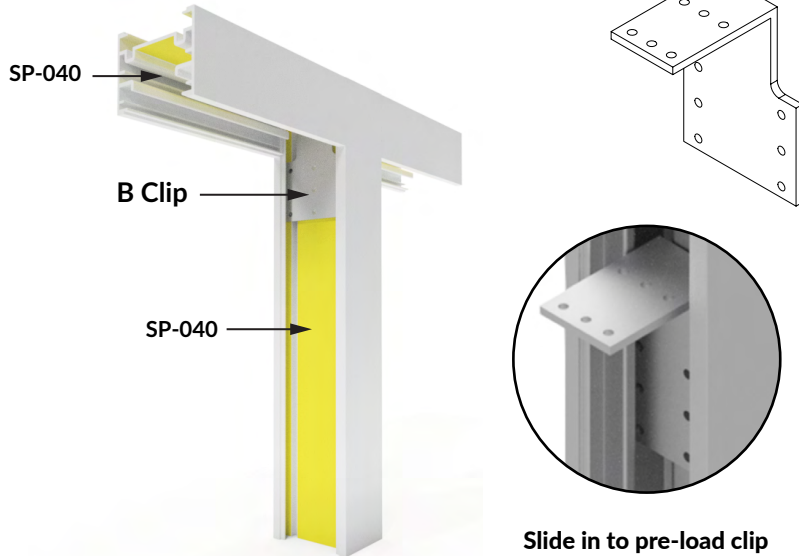

C CLIP

Sliding Door Header Clip

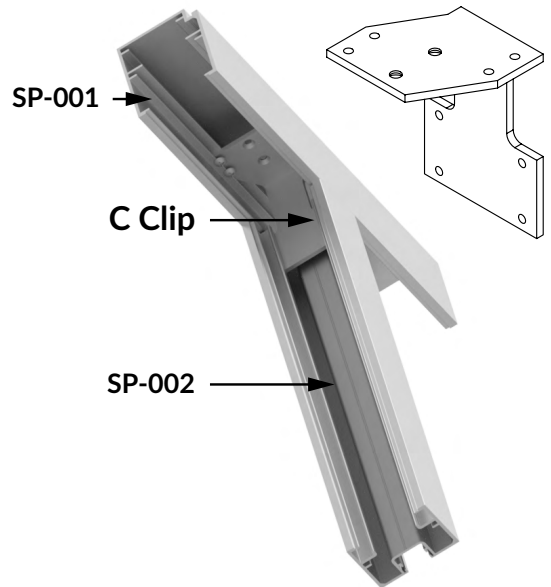

D CLIP

Horizontal Mullion Clip

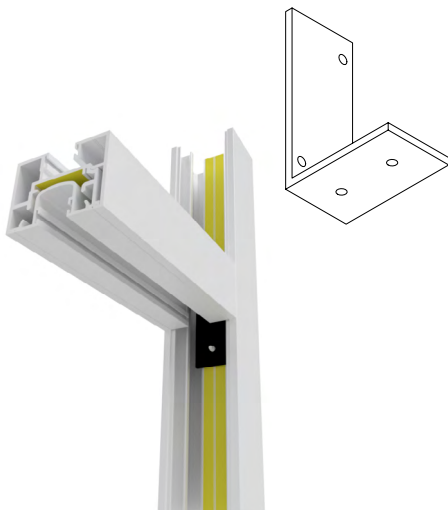

E CLIP

Shallow Glazing Channel to Horizontal Mullion Clip

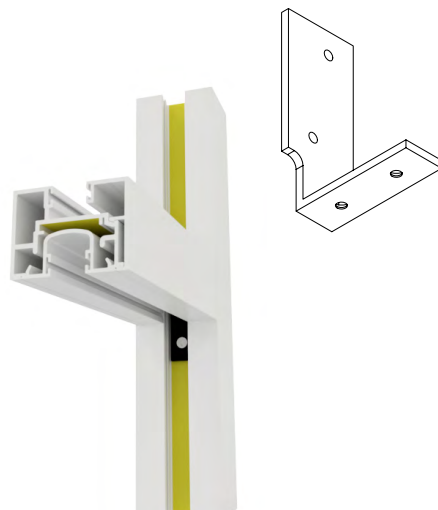

F CLIP

Vertical to Base Setting Channel "Floor" Clip

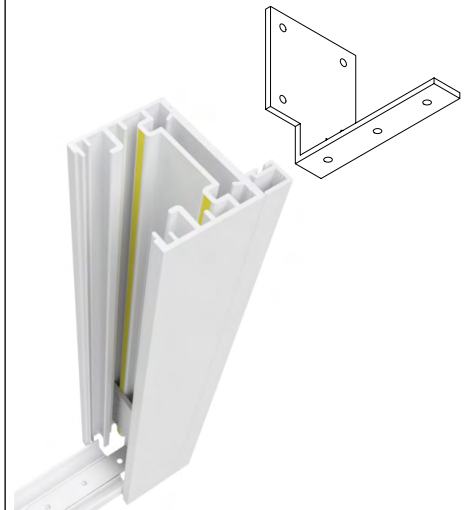

For visibility, we've highlighted the surfaces within the LiteSpace profiles that clips are secured to in many areas of this document.

Design & Installation Guide - LiteSpace Interior Aluminum Framing

Installation: 3-Sided Frame

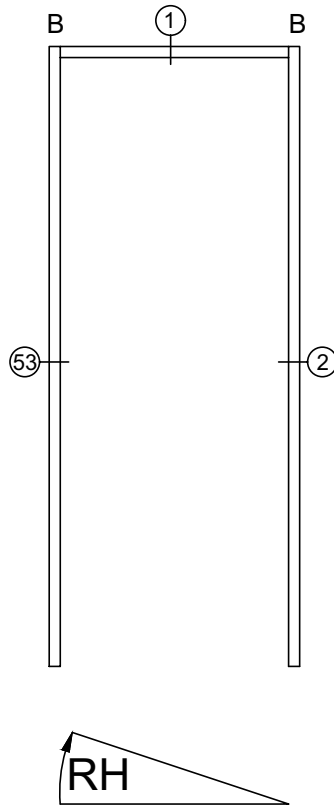

Parts supplied by Special-Lite:

- SP-038 Base Setting Channel
- SP-040 H-Mullion
- SP-039 Door Stop
- SP-028 Hinge Reinforcement (*factory installed at butt hinge locations*)
- B-Clip Vertical Mullion Clip
- Door mute (*factory installed or loose*)

Tools required:

- Miter saw
- Drill
- Screwdriver
- Screws and/or fasteners
- Spreader bar
- Measuring tape
- Level

IMPORTANT:

- All door mute materials must be pulled in before installation.
- All fasteners must be countersunk.

Design & Installation Guide - LiteSpace Interior Aluminum Framing

1. Install the vertical base setting channels on hinge and lock jamb sides of opening.

- A. Determine the height of the rough opening.
- B. Measure and cut the SP-038 Base Setting Channel to the full height of rough opening for hinge and strike side of door opening.
- C. Secure SP-038 Base Setting Channel to both finished walls.

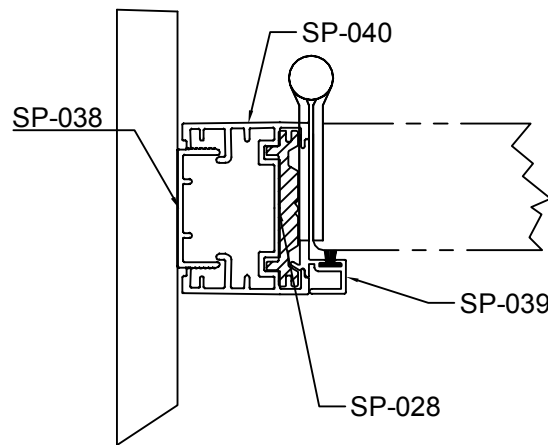

Detail Drawing 39

2. Install the vertical H-Mullion on the hinge jamb side of opening.

- A. Locate corresponding hinge assembly, including SP-040 H-Mullion, SP-028 Hinge Reinforcement, and SP-039 Door Stop.
- B. Remove SP-028 Hinge Reinforcement and SP-039 Door Stop from hinge assembly and place to the side.
- C. Measure the rough opening height and trim the top of hinge assembly to achieve the correct hinge location from underside of opening to the top of hinge.
- D. Measure and cut the SP-040 H-Mullion at the bottom to match the rough opening height. Allow space for finished floor if necessary.
- E. Subtract 3" from rough opening height and cut SP-028 Hinge Reinforcement to length.
- F. Slide the SP-028 Hinge Reinforcement into SP-040 H-Mullion and pre-load the B-Clip into the top of vertical SP-040 H-Mullion.
- G. Snap the SP-040 H-Mullion to SP-038 Base Setting Channel on the hinge side of the door and secure by fastening through both into the wall.

3. Install the horizontal H-Mullion at the head.

- A. Determine the width of the door opening and cut the SP-040 H-Mullion to length.
- B. Secure the SP-040 H-Mullion at head.
- C. Slide the B-Clip up and secure it to the SP-040 H-Mullion at the head and then to the SP-040 H-Mullion at the hinge jamb.

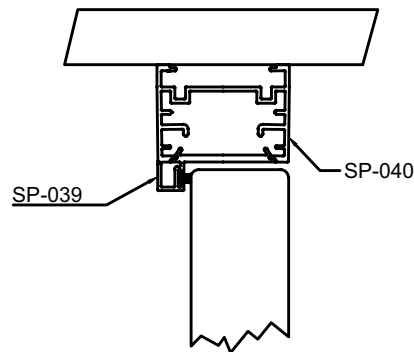

Detail Drawing 1

4. Install vertical H-Mullion on strike jamb side of opening.

- A. Determine rough opening height.
- B. Locate corresponding strike jamb assembly, including SP-040 H-Mullion and SP-039 Door Stop.
- C. Remove SP-039 Door Stop from strike jamb assembly and place to side.
- D. Trim the top of the SP-040 H-Mullion, to achieve the correct strike location.
- E. Measure and cut SP-040 H-Mullion at bottom to desired length, allowing space for finished floor.
- F. Pre-load B-Clip to vertical SP-040 H-Mullion at the header.
- G. Snap SP-040 H-Mullion to SP-038 Base Setting Channel on the strike side of the door and secure by fastening through both into the wall.
- H. Slide the B-Clip up and secure to SP-040 H-Mullion at head and then to SP-040 H-Mullion at strike jamb.

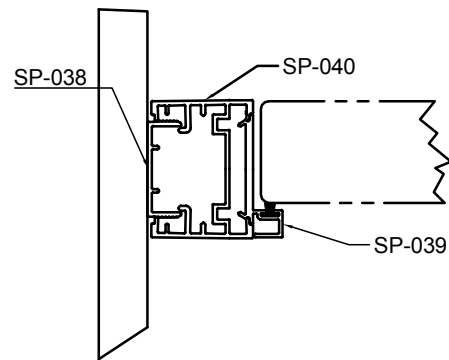

Detail drawing 53

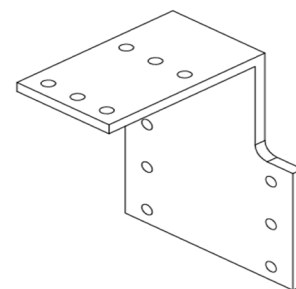

B-clip

5. Install door stops.

- A. Measure the SP-039 Door Stop to the desired width for the door at the head.
- B. Cut both ends of horizontal SP-039 Door Stop at 45-degree angle.
- C. Snap in the SP-039 Door Stop to the horizontal SP-040 H-Mullion at the head.
- D. Ensure the prep location on the hinge assembly (SP-040 H-Mullion, SP-028 Hinge Reinforcement, and SP-039 Door Stop) is aligned.
- E. Cut the vertical SP-039 Door Stop at a 45-degree angle at the head.
- F. Snap the vertical SP-039 Door Stop to vertical SP-040 H-Mullion on hinge side of door.
- G. Repeat steps 4-6 on the strike jamb side of door, ensuring that the strike preps are aligned.
- H. Measure the SP-039 Door Stop to fit between the hinge prep locations and allow for the finished floor at the bottom.

Installation: Swing Door with Sidelite

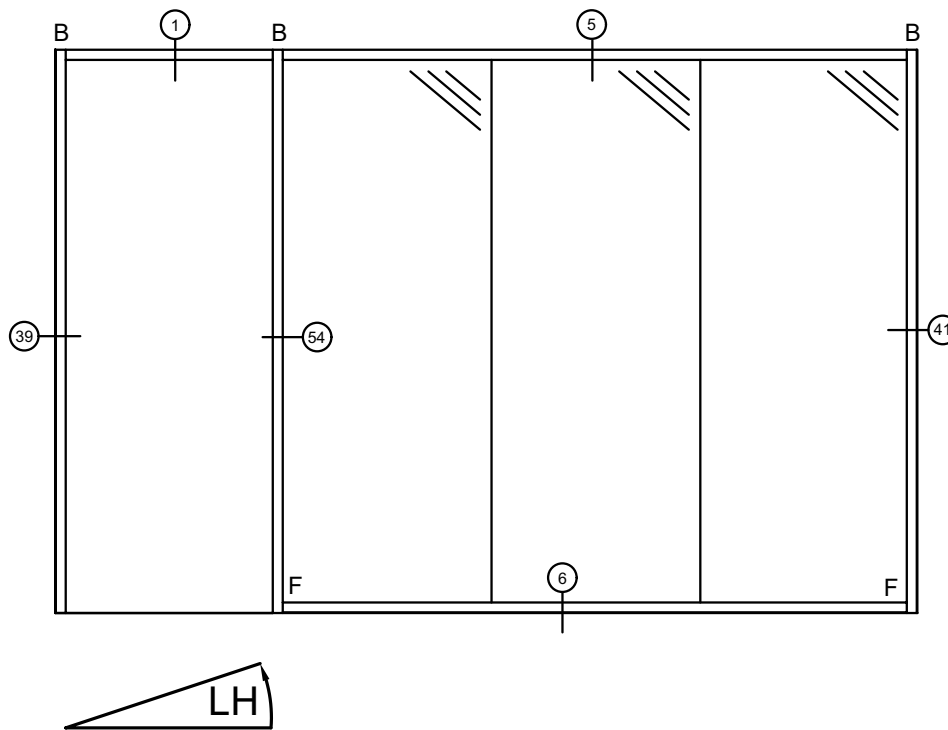

Parts supplied by Special-Lite:

- SP-010 Floor Base Setting Channel
- SP-038 Base Setting Channel
- SP-040 H-Channel Stud
- SP-039 Snap-In Door Stop
- SP-002 Shallow Glazing Channel
- SP-003 Deep Glazing Insert Channel
- SP-028 Hinge Reinforcement (factory installed at butt hinge locations)
- B-Clip Mullion Clip
- F-Clip Frame Vertical To Base Setting Channel
- Glazing bulb (factory installed or loose)
- Glazing tape
- Door mute (factory installed or loose)

Tools required:

- Miter saw
- Drill
- Screwdriver
- Screws and/or fasteners
- Spreader bar
- Measuring tape
- Level

IMPORTANT:

- All glazing bulb and door mute materials must be pulled into profiles before installation.
- Notching or inseting parts to leave room for clips will affect glass measurements.
- **All fasteners must be countersunk.**

Design & Installation Guide - LiteSpace Interior Aluminum Framing

1. Install vertical Base Setting Channels on the hinge jamb and the opposite wall.

- A. Determine the size of the drywall finished opening.
- B. Measure and cut SP-038 Base Setting Channel to the full height of the opening for the hinge side of the door.
- C. Measure and cut SP-038 Base Setting Channel to the full height of the opposite wall.
- D. Secure SP-038 Base Setting Channel to both finished walls.

2. Install vertical H-Mullion and Reinforcement on the hinge jamb of the opening.

- A. Locate corresponding hinge jamb assembly profiles (Detail Drawing 3), SP-040 H-Mullion, SP-028 Reinforcement, and SP-039 Door Stop.
- B. Remove SP-028 Reinforcement and SP-039 Door Stop from hinge jamb assembly and place to the side.
- C. Measure the finished opening height and trim the top of SP-040 H-Mullion to achieve the correct hinge location from underside of opening to top of hinge.
- D. Measure and cut SP-040 H-Mullion at the bottom to match the finished opening height. Allow space for finished floor if necessary.
- E. Subtract 4" from drywall finished opening height and cut SP-028 Reinforcement to length.
- F. Slide SP-028 Reinforcement into SP-040 H-Mullion profile and pre-load B-clip into the top of the vertical SP-040 H-Mullion.
- G. Snap SP-040 to SP-038 on the hinge side of the door and secure by fastening through both into the wall.

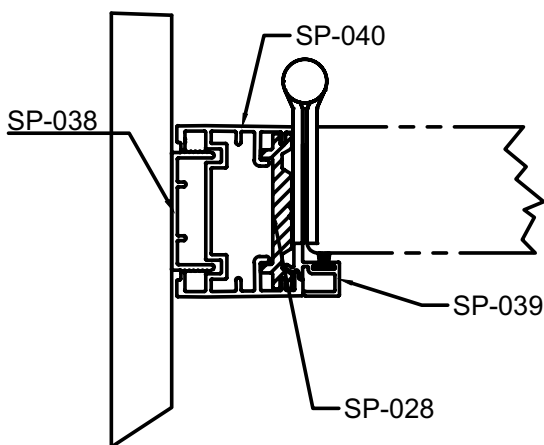

Detail Drawing 3

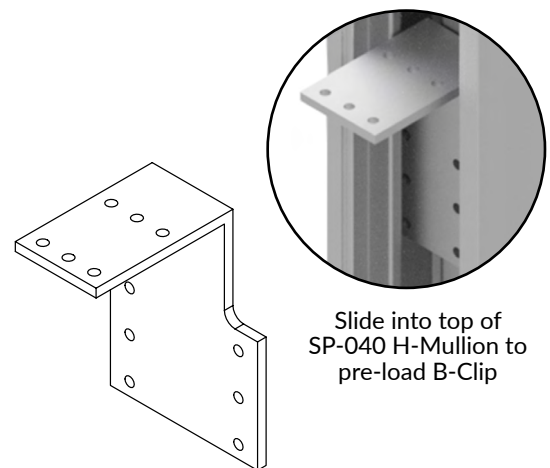

Slide into top of SP-040 H-Mullion to pre-load B-Clip

Pre-load B-Clip

Design & Installation Guide - LiteSpace Interior Aluminum Framing

3. Install Horizontal H-Mullion at head.

- A. Determine the width of the door opening and cut SP-040 H-Mullion to size.
- B. Secure SP-040 H-Mullion at the head.

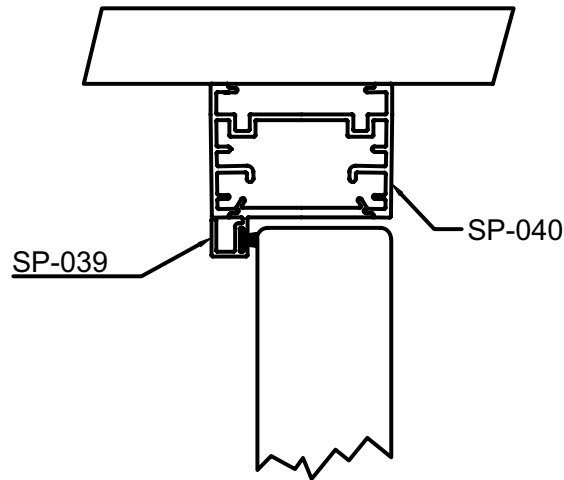

Detail Drawing 1

- C. Slide the B-Clip up to the head of the opening. Secure B-Clip to the SP-040 H-Mullion at the head and then to the SP-040 H-Mullion at the hinge jamb.

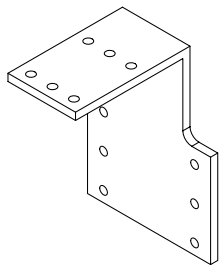

B-Clip

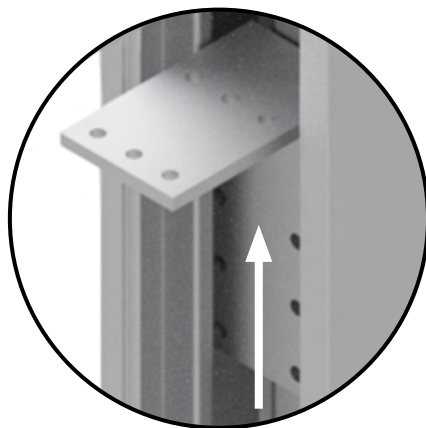

Slide up to head to secure



Secure at head, then hinge jamb

Securing B-Clip

4. Install vertical H-Mullion on the strike jamb.

- A. Determine drywall finished opening height.
- B. Locate corresponding strike jamb assembly, including SP-040 H-Mullion and SP-039 Door Stop.

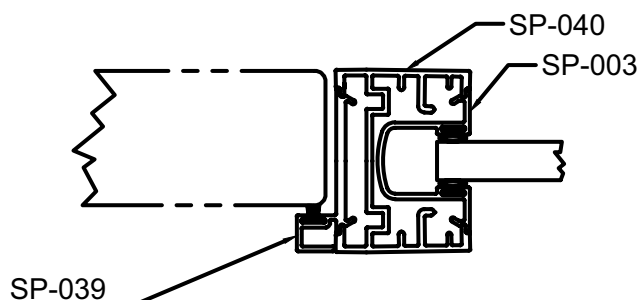

Detail Drawing 54

- C. Remove SP-039 Door Stop from strike jamb assembly and place to side.
- D. Trim top of SP-040 H-Mullion to achieve correct strike location.
- E. Measure and cut the SP-040 H-Mullion at the bottom to the desired length, allowing space for the finished floor.
- F. Pre-load the B-Clip into the vertical SP-040 H-Mullion at header and pre-load the F-Clip to the backside of strike jamb at the bottom to secure to the floor.
- G. Slide the B-Clip up and secure to SP-040 H-Mullion at head and then to SP-040 H-Mullion at the strike jamb.

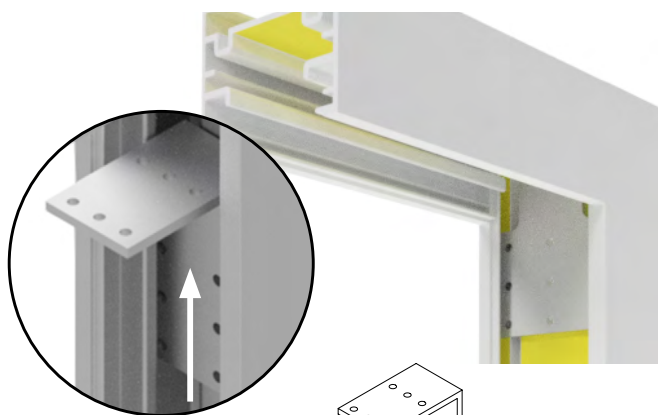

Pre-load and slide up to head to secure

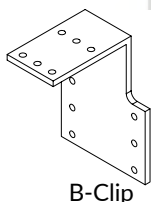

B-Clip

Installing B-Clip

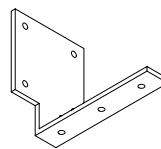

F-Clip

Pre-load and slide down to secure to floor

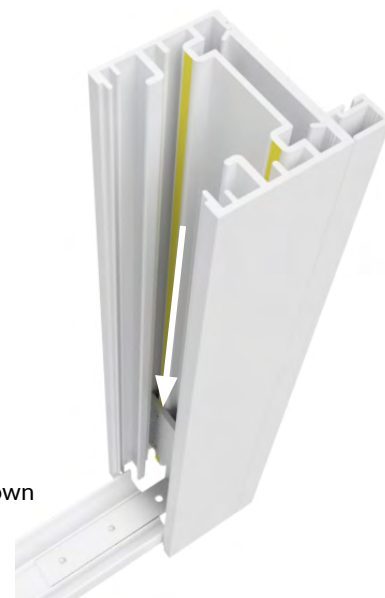

Installing F-Clip

5. Install door stops.

- A. Measure SP-039 Door Stop to desired width for door at header.
- B. Cut both ends of horizontal SP-039 Door Stop at a 45-degree angle.
- C. Snap and secure horizontal SP-039 Door Stop to horizontal SP-040 H-Mullion at header.
- D. Ensure prep location on hinge jamb assembly (SP-040 H-Mullion, SP-028 Reinforcement, and SP-039 Door Stop) is aligned.
- E. Measure SP-039 Door Stop to desired length for hinge side of door, allowing space for finished floor on bottom. Line up with hinge prep locations.
- F. Cut vertical SP-039 Door Stop at a 45-degree angle at header.
- G. Snap the vertical SP-039 Door Stop on to the vertical SP-040 H-Mullion on the hinge side of the door.
- H. Repeat steps D-G on the strike jamb side of the frame, ensuring that strike preps are aligned.

6. Install Glazing Channel to end of opening.

- A. Measure and cut SP-002 Shallow Glazing Channel (or alternately you may use SP-040 H-Mullion and SP-003 Deep Glazing Insert Channel) to the full height of opening.
- B. Pre-load B-Clip to SP-002 Shallow Glazing Channel (or SP-040 H-Mullion) at head.
- C. Pre-load F-Clip at bottom of SP-002 Shallow Glazing Channel (or SP-040 H-Mullion) at end of opening.
- D. Snap SP-002 Shallow Glazing Channel (or SP-040 H-Mullion) to SP-038 Base Setting Channel at the end of the opening. If using the SP-040 H-Mullion option, additionally snap in the SP-003 Deep Glazing Insert Channel.

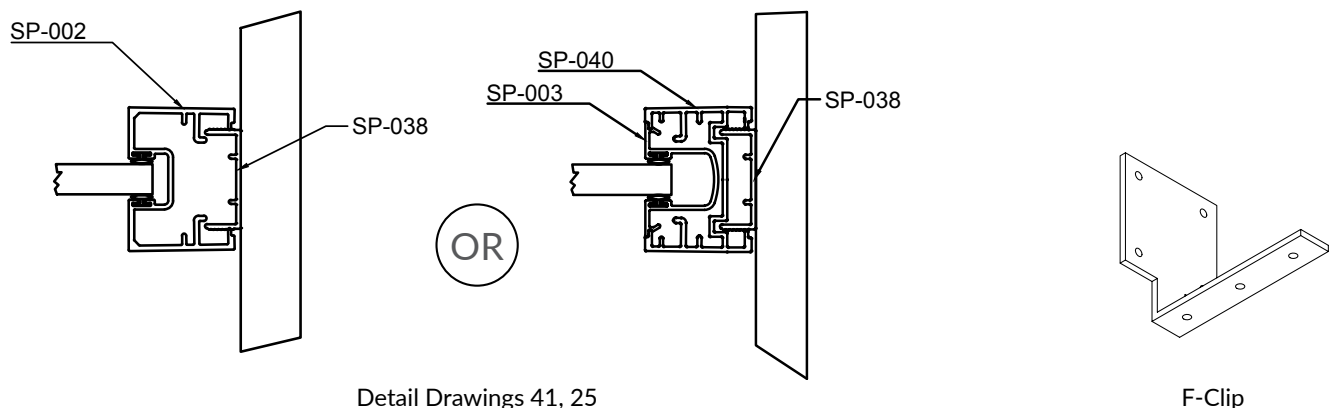

Design & Installation Guide - LiteSpace Interior Aluminum Framing

7. Install vertical Deep Glazing Insert Channel to the left side of the sidelite.

- A. Measure Daylight Opening (DLO) at sill to underside of header.
- B. Trim SP-003 Deep Glazing Insert Channel to desired width.
- C. Notch the SP-003 Deep Glazing Insert Channel to make room for clips. Measure 3" from the edge, then cut from the edge into the glazing pocket to notch the channel as shown below.
- D. Snap SP-003 Deep Glazing Insert Channel into the backside of the strike jamb.

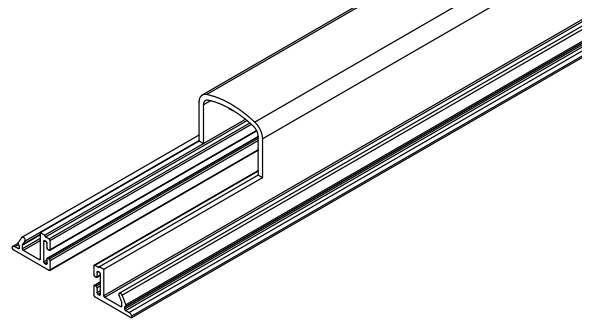

Notched SP-003 Deep Glazing Insert Channel

8. Install sidelite H-Mullion at head and snap in Deep Glazing Insert.

- A. Measure width between vertical SP-040 H-Mullion on strike jamb side of door and Glazing Channel on the end of the opening.
- B. Cut horizontal SP-040 H-Mullion and SP-003 Deep Glazing Insert Channel to desired width.
- C. Secure SP-040 H-Mullion to header.
- D. Snap the SP-003 Deep Glazing Insert Channel into the horizontal SP-040 H-Mullion at the head.

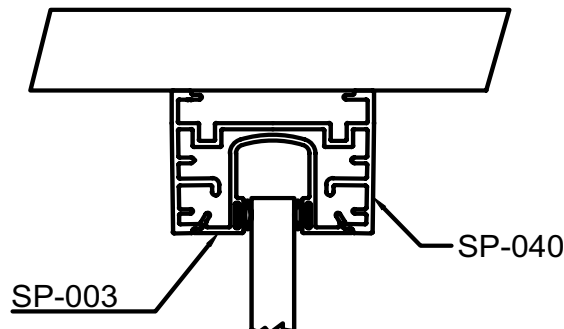

Detail Drawing 5

9. Install Base Receiving Channel and Shallow Glazing Channel at sill.

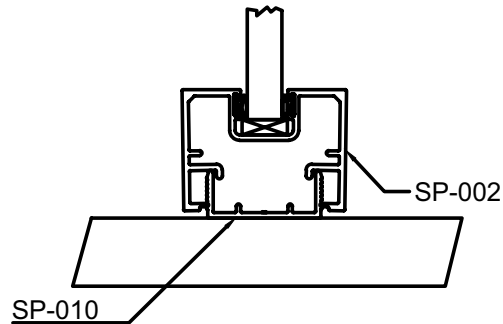

Detail Drawing 6

IMPORTANT:

All glazing bulb and door mute materials must be pulled in before installation.

- A. Measure width between SP-040 H-Mullion on strike jamb side of door and SP-002 Shallow Glazing Channel on end of opening.
- B. Cut SP-002 Shallow Glazing Channel to desired width.
- C. Add ½" to the last measurement and cut SP-010 Tall Base Setting Channel to length (7/16" max for use with SP-002 Shallow Glazing Channel).
- D. Place SP-010 Tall Base Setting Channel at sill.
- E. Use preloaded F-clips on SP-040 on strike jamb side of door and on SP-002 Shallow Glazing Channel at end of opening to align and secure horizontal SP-010 Tall Base Setting Channel.
- F. Install additional anchors every 18" on center.
- G. Snap horizontal SP-002 Shallow Glazing Channel to SP-010 Tall Base Setting Channel at floor.

Installation: Sliding SLI Door with Sidelite

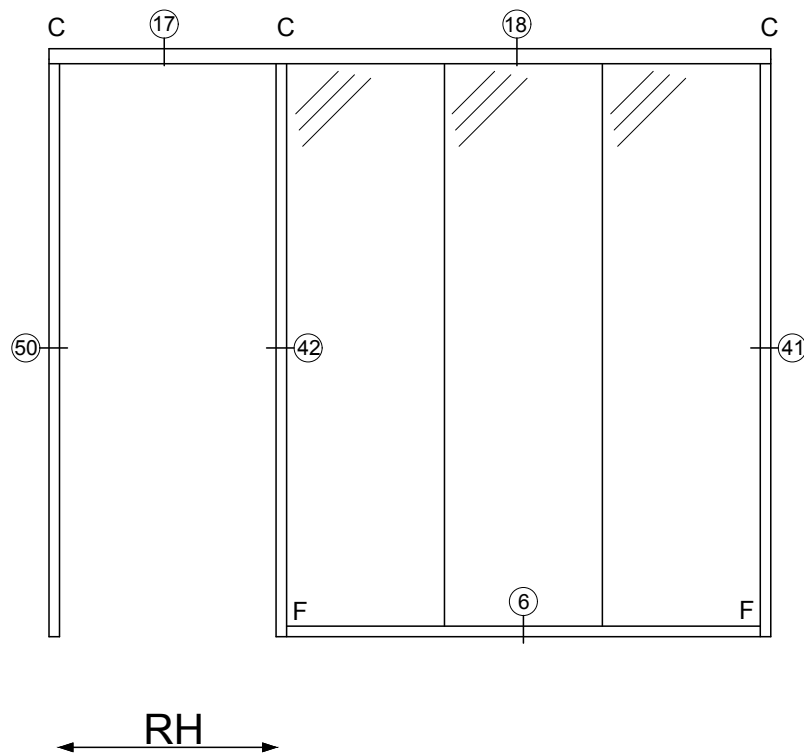

Parts supplied by Special-Lite:

- SP-001 Short Sliding Track Header
- SP-038 Base Setting Channel
- SP-037 1-3/4" Door Receiving Channel
- SP-034 Sliding Door Post
- SP-002 Shallow Glazing Channel
- SP-004 Snap-In Channel Cover
- SP-003 Deep Glazing Insert Channel
- SP-032 Short-Profile Slider Track
- SP-033 Short-Profile Track Fascia
- C-Clip Twist Clip
- F-Clip Frame Vertical To Base Setting Channel
- Glazing bulb (factory installed or loose)
- End cap

Tools required:

- Miter saw
- Drill
- Screwdriver
- Screws and/or fasteners
- Spreader bar
- Measuring tape
- Level

IMPORTANT:

- Before installation, determine whether sliding door will be an out-slider (sliding in front of the glass) or an in-slider (sliding behind the glass.)
- All glazing bulb and door mute materials must be pulled into profiles before installation.
- Notching or inseting parts to leave room for clips will affect glass measurements.
- **All fasteners must be countersunk.**

Design & Installation Guide - LiteSpace Interior Aluminum Framing

1. Install sliding track header.

- A. Measure and cut SP-001 Short Sliding Track Header to entire width of opening for header.
- B. Secure SP-001 Short Sliding Track Header.

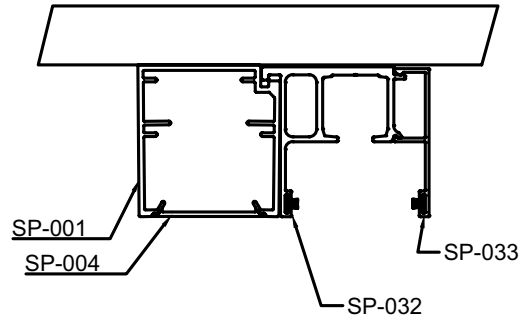

Detail Drawing 17

2. Install base setting channel for both sides of opening.

- A. Measure and cut SP-038 Base Setting Channel to desired length for opening side on left, allowing space for finished floor on bottom.
- B. Measure and cut SP-038 Base Setting Channel to desired length for opening side on right, allowing space for finished floor on bottom.
- C. Secure SP-038 Base Setting Channel to finished walls.

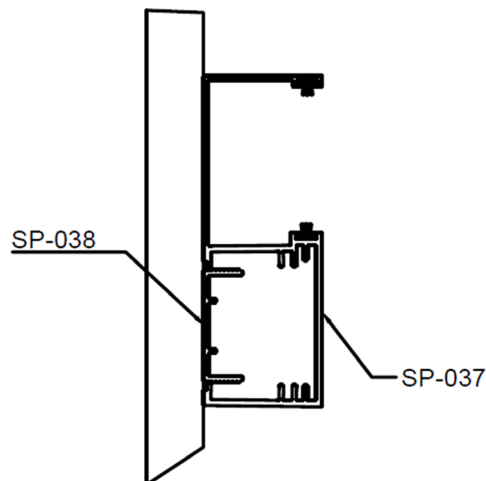

Detail Drawing 50

3. Install door receiving channel.

- A. Measure and cut SP-037 1-3/4" Door Receiving Channel to desired length for opening side on left, allowing space for the finished floor on the bottom.
- B. Snap and secure the SP-037 1-3/4" Door Receiving Channel to the SP-038 Base Setting Channel and secure to the wall.

4. Install sliding door post.

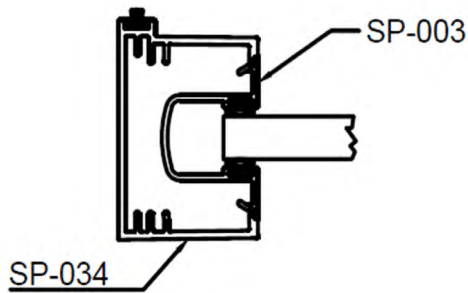

Detail Drawing 42

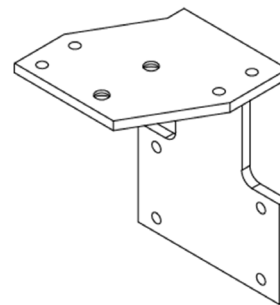

C-Clip

- A. Determine the size of the door opening.
- B. Measure and cut SP-034 Sliding Door Post to the desired length on the stationary panel side of the sliding door, allowing space for the finished floor on the bottom.
- C. Use a spreader bar to maintain the opening size.
- D. Pre-load a C-Clip to the SP-034 Sliding Door Post at the head.
- E. Pre-load F-Clip at the floor.
- F. Use C-Clip to secure SP-034 Sliding Door Post to SP-001 Short Sliding Track Header.

5. Install the glazing channel to the end of the opening.

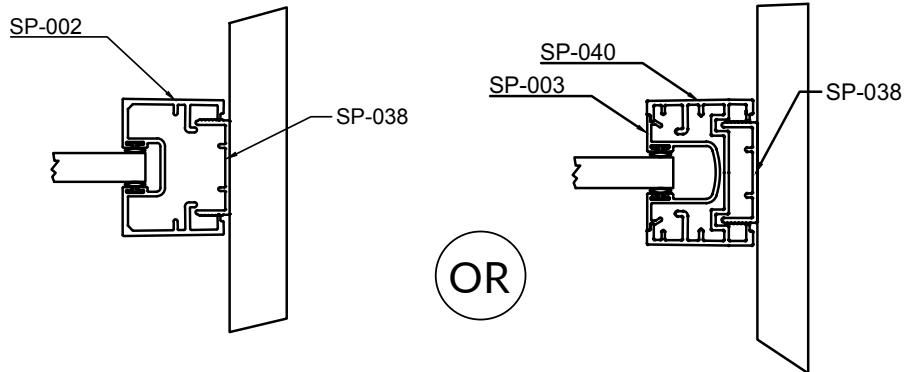

Detail Drawing 41, 25

- A. Measure and cut SP-002 Shallow Glazing Channel (or alternately you may use SP-040 H-Mullion and SP-003 Deep Glazing Insert Channel) to desired length.
- B. Snap and secure SP-002 Shallow Glazing Channel (or SP-040) to SP-038 Base Setting Channel at the end of the opening.

6. Install the base receiving channel and shallow glazing channel at the sill.

IMPORTANT: All glazing bulb and door mute materials must be pulled in before installation.

- A. Measure the width between the SP-034 Sliding Door Post and the vertical SP-002 Shallow Glazing Channel on the end of opening, keeping the SP-034 Sliding Door Post square and at the correct door opening measurement.
- B. Cut the SP-010 Tall Base Setting Channel and the SP-002 Shallow Glazing Channel to the desired width.
- C. Use preloaded F-clips on the SP-034 Sliding Door Post on the stationary panel side of the door and secure SP-010 Tall Base Setting Channel at the floor.
- D. Install additional anchors every 18" on center.
- E. Snap and secure the horizontal SP-002 Shallow Glazing Channel to the SP-010 Tall Base Setting Channel at the floor.

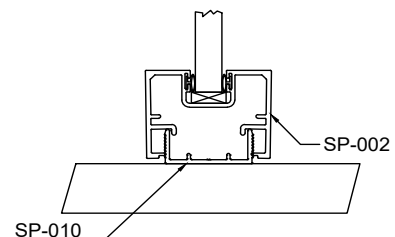

Detail Drawing 6

7. Install snap-in channel cover.

- A. 1. Measure and cut the SP-004 Snap-In Channel Cover to the desired width.
- B. Snap the SP-004 Snap-In Channel Cover to SP-001 Short Sliding Track Header.

8. Install deep glazing insert channel at header.

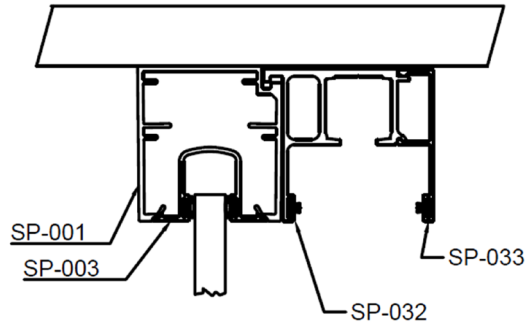

Detail Drawing 18

- A. Measure the width between the SP-034 Sliding Door Post and the vertical SP-002 Shallow Glazing Channel on the end of the opening.
- B. Measure and cut the SP-003 Deep Glazing Insert Channel to the desired width.
- C. Snap and secure the SP-003 Deep Glazing Insert Channel to the SP-001 Short Sliding Track Header at the head.

9. Install short-profile slider track.

IMPORTANT: If the sliding track runs the full width of the opening, the hardware must be installed in the track prior to installation of SP-032 Short Sliding Door Track.

- Do not engage the hardware before installation.
- SP-032 Short Sliding Door Track should not be seamed in door operating area.
 - A. Measure and cut the SP-032 Short Sliding Door Track to desired width.
 - B. Pre-load soft close into the track (if not pre-installed) and slide in.
 - C. Using the groove in the SP-001 Short Sliding Track Header and lip on SP-032 Short Sliding Door Track as guide, pull SP-032 flush with SP-001.
 - D. Countersink fasteners to secure SP-032 Short Sliding Door Track to header, ensuring the top of it is flush with the top of SP-001 Short Sliding Track Header.

10. Install sliding door.

- A. Install sliding door.
- B. Adjust stops on either side of door to the desired points.
- C. Use installed door to engage soft closes where applicable. Consult manufacturer's installation manual for more detail.

11. Install short sliding door track fascia.

- A. Measure and cut SP-033 Short Sliding Door Track Fascia to the desired width.
- B. Snap SP-033 Short Sliding Door Track Fascia to SP-032 Short Sliding Door Track.
- C. Install end caps (if applicable).

12. Install deep glazing insert channel to sliding door post.

- A. Measure the length between the SP-001 Short Sliding Track Header and the SP-002 Shallow Glazing Channel at the sill.
- B. Cut the SP-003 Deep Glazing Insert Channel to the desired length.
- C. Notch the SP-003 Deep Glazing Insert Channel to make room for clips. Measure 3" from the edge, then cut from the edge into the glazing pocket to notch the channel as shown below.
- D. Snap the SP-003 Deep Glazing Insert Channel to the SP-034 Sliding Door Post.

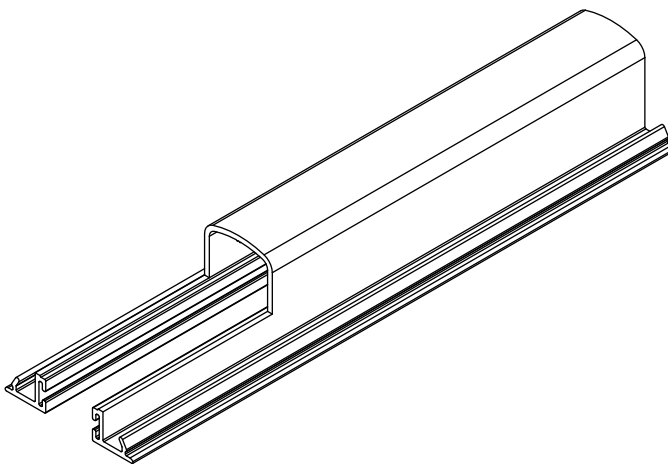

Notched SP-003

Miter Cut Rules for Returns

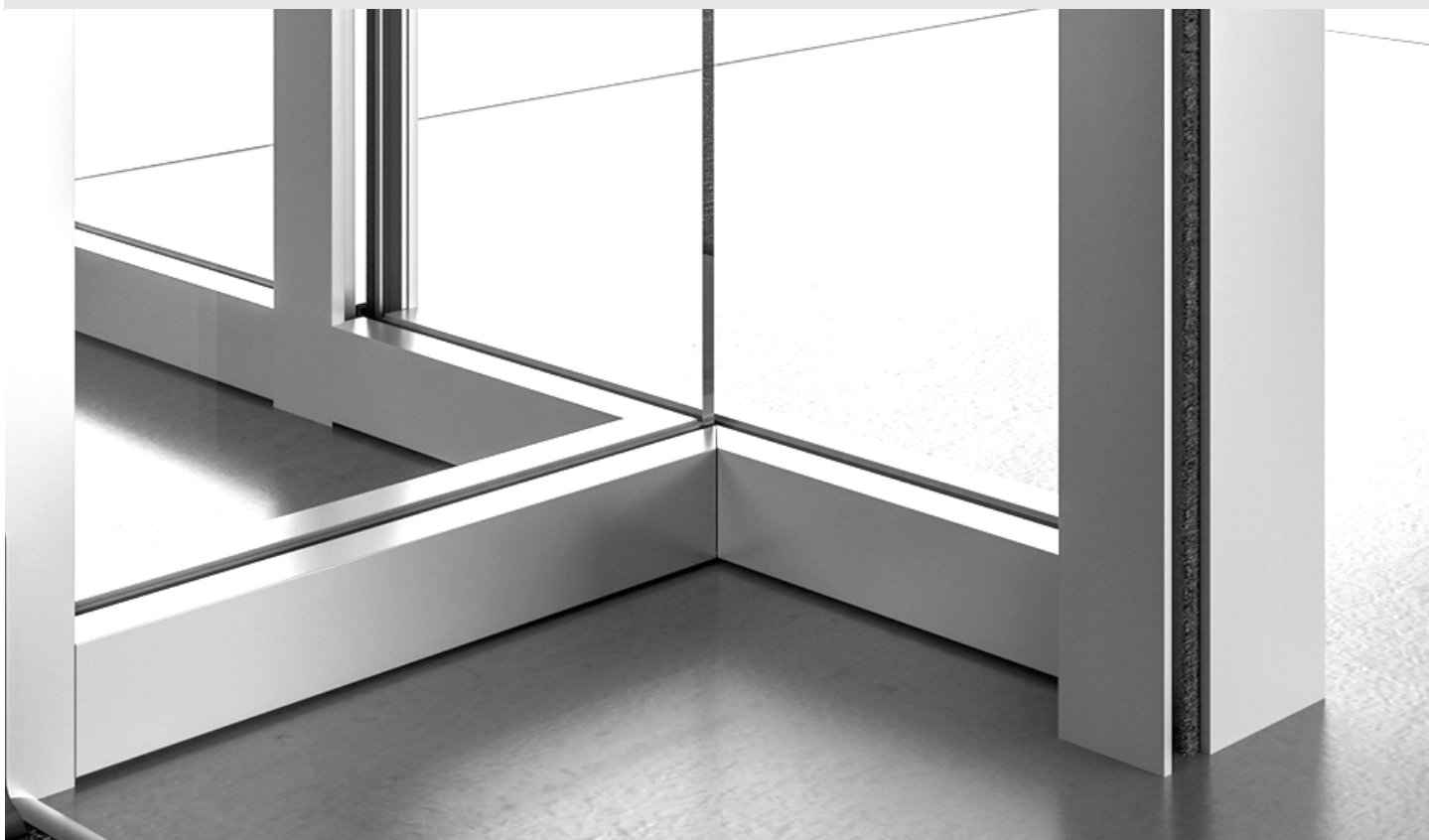

For configurations with 45 and 90 degree returns, additional cuts may be necessary at the header and sill as detailed below. SP-038 Base Setting Channel does not need to be cut.

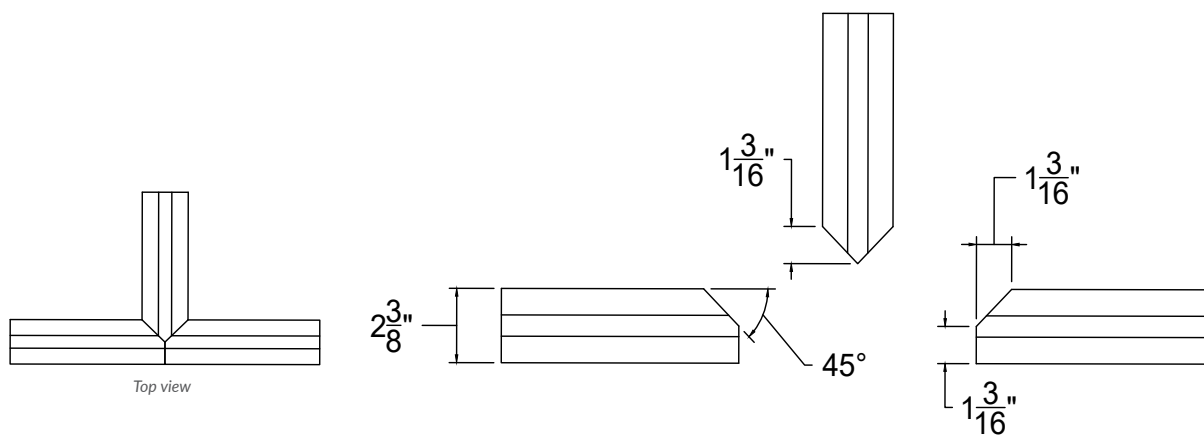

Note: These parts are butt joint and Special-Lite does not provide clips in these conditions.

Design & Installation Guide - LiteSpace Interior Aluminum Framing

How to Measure for Glass

B* - B CLIP MUST BE PRELOADED, IF NOT A D CLIP CAN BE USED

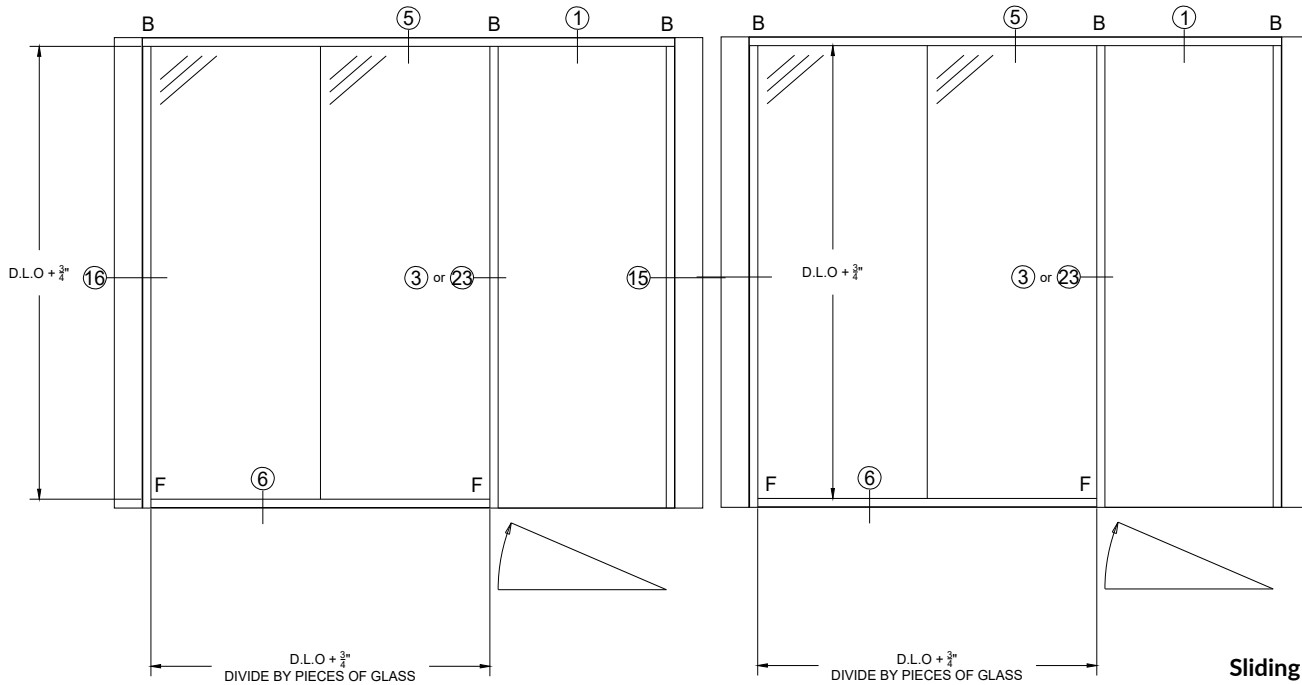

Sliding Glass Door - Tall Track (for SP-030 & SP-031 Configuration)

Add 2 1/2" to D.O. width for net door width and add 3/4" to D.O. height for net door height

Sliding SLI Door:

Add 2 1/4" to D.O. width for net door width and add 5/16" to D.O. height for net door height.

Sliding Glass Door - Short Track (for SP-043 & SP-044 configuration.)

Reference page 33 for patch fitting hardware template.

Add 2 1/2" to D.O. width for net door width and add 0" to D.O. height for net door height.

Note: The door sizing in these three examples allows for 1/4" gap at the floor. If more gap is needed, adjustments will be necessary.

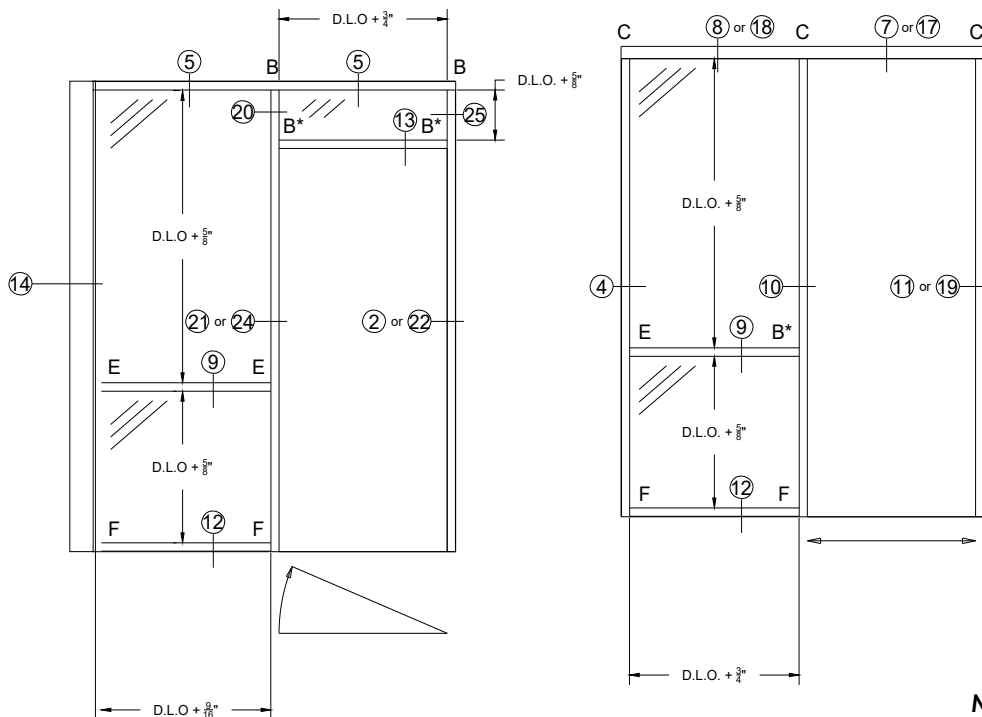

Design & Installation Guide - LiteSpace Interior Aluminum Framing

Profile Names and Numbers

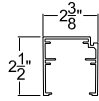

SP-001
Short Sliding Track Header

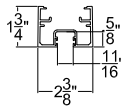

SP-002
Shallow Glazing Channel

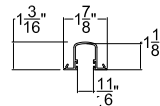

SP-003
Deep Glazing Insert Channel



SP-004
Snap-In Channel Cover

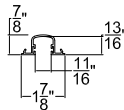

SP-005
Shallow Glazing Insert Channel



SP-007
LiteSpace, Concealed Closer Option



SP-010
Tall Base Setting Channel

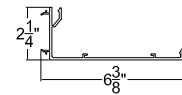

SP-011
LiteSpace, Bi-Pass Wall Connector, 6" Wide

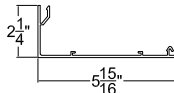

SP-012
LiteSpace, Bi-Pass Wall Cap, 6" Wide



SP-020
Glass Snap

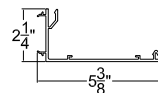

SP-023
Bi-Pass Wall Connector, 5" Wide

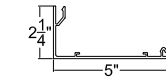

SP-024
Bi-Pass Wall Cap, 5" Wide



SP-028
Hinge/Latch Reinforcement

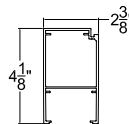

SP-029
Tall Sliding Track Header

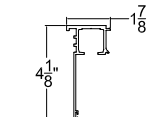

SP-030
Tall Sliding Glass Door Track

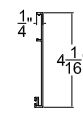

SP-031
Tall Sliding Glass Door Track Fascia



SP-032
Short Sliding 1-3/4" Door Track



SP-033
Short Sliding 1-3/4" Door Track Fascia



SP-034
Sliding Door Post

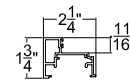

SP-035
Base

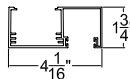

SP-036
Glass Door Receiving Channel

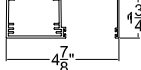

SP-037
1-3/4" Door Receiving Channel



SP-038
Base Setting Channel



SP-039
Door Stop



SP-040
H-Mullion

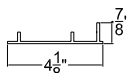

SP-041
Tall Sliding Glass Door End Cap



SP-042
1-3/4" Sliding Door End Cap



SP-043
Short Sliding Glass Door Track



SP-044
Short Sliding Glass Door Track Fascia



SP-045
Short Sliding Glass Door End Cap

Design & Installation Guide - LiteSpace Interior Aluminum Framing

Profile Assemblies

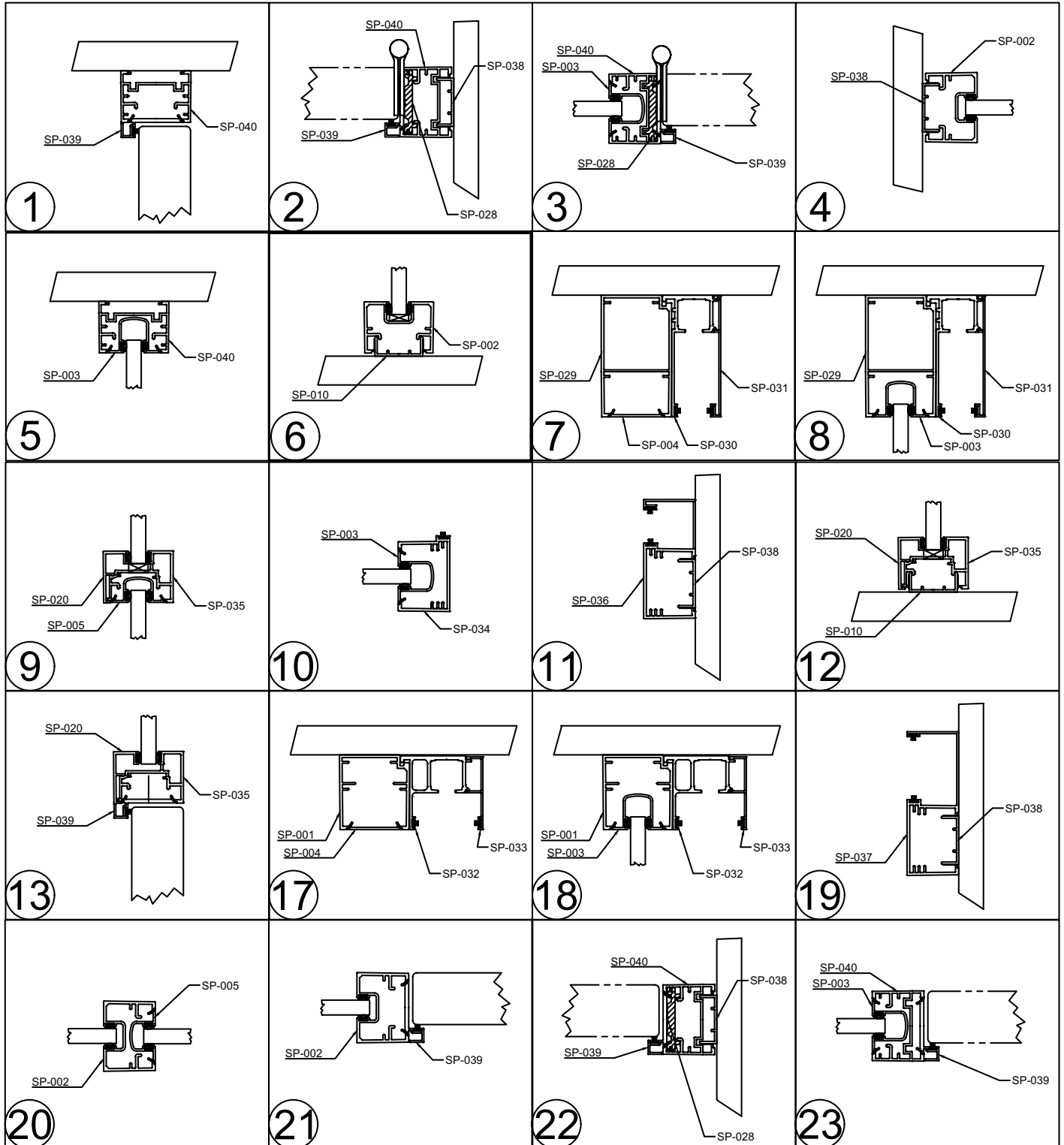

Profile Assemblies

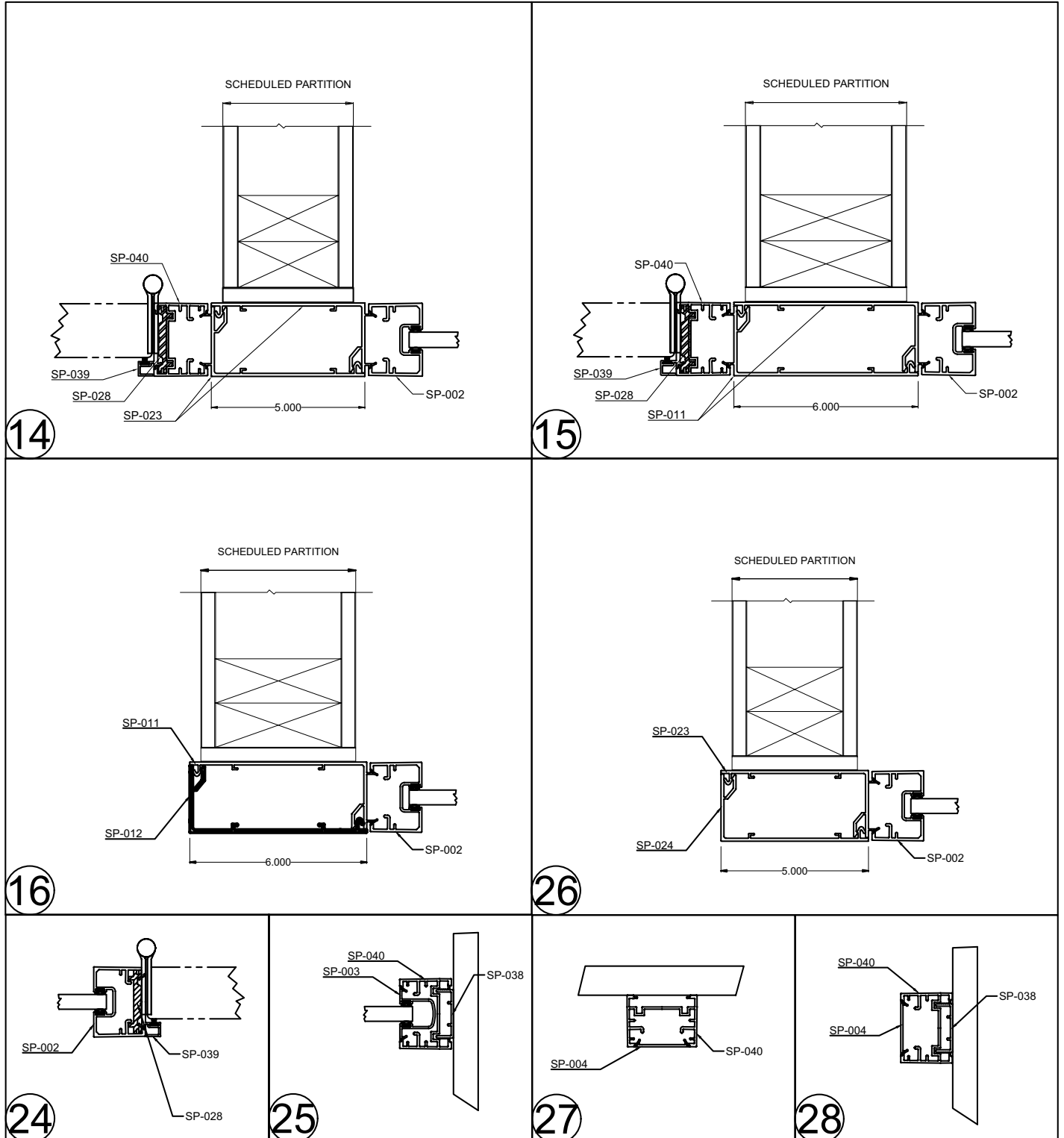

Profile Assemblies

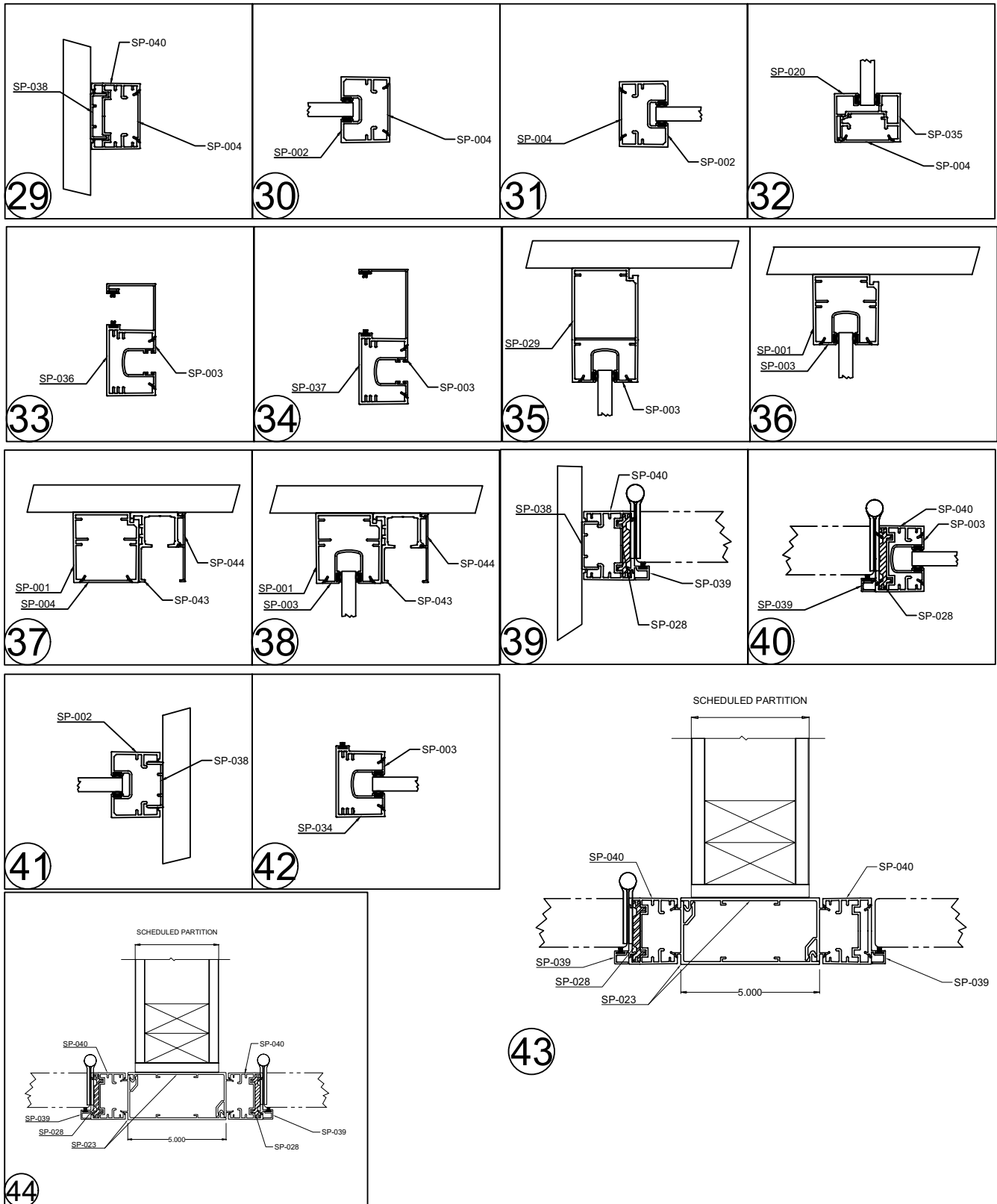

Design & Installation Guide - LiteSpace Interior Aluminum Framing

Profile Assemblies

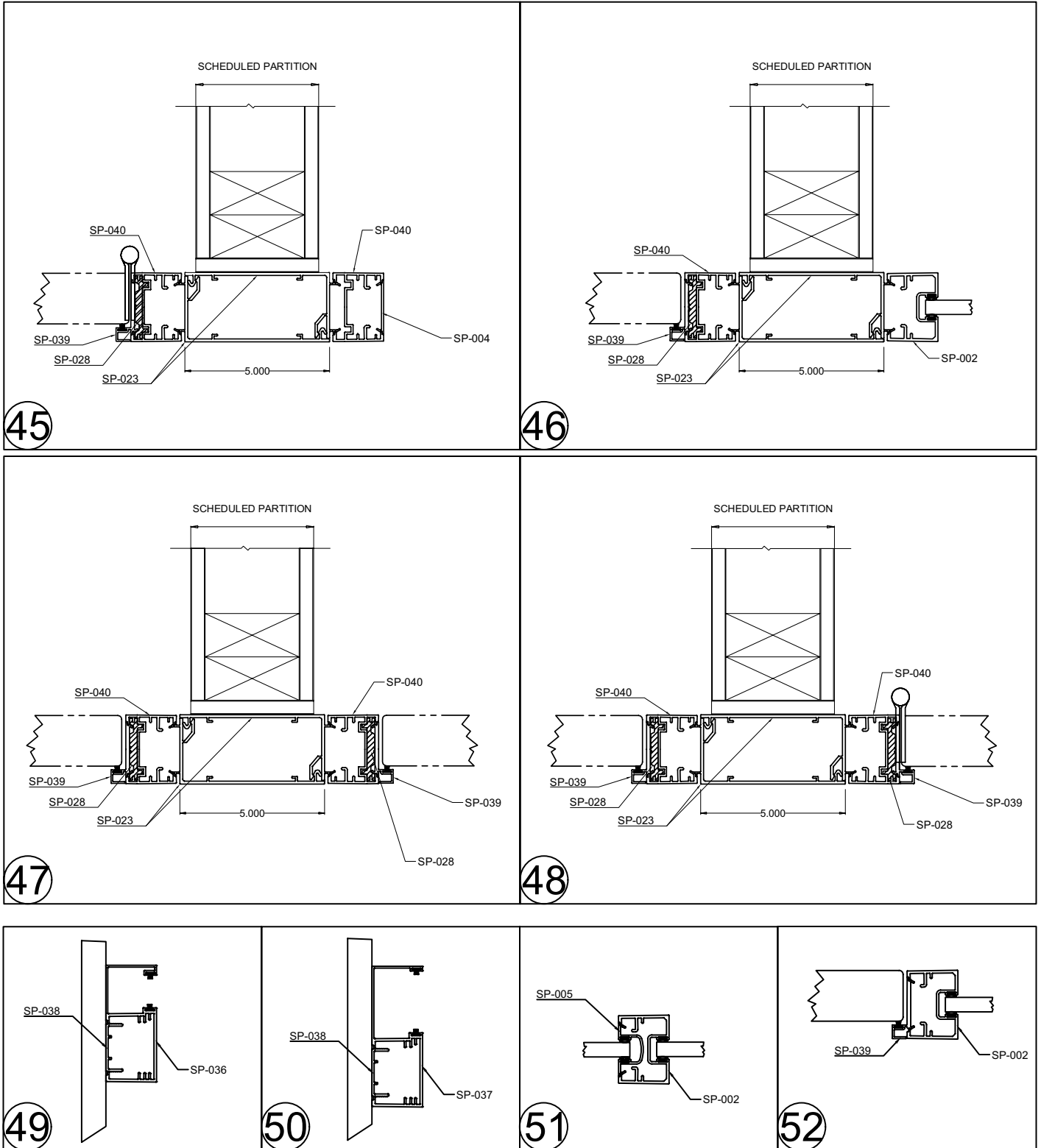

Design & Installation Guide - LiteSpace Interior Aluminum Framing

Profile Assemblies

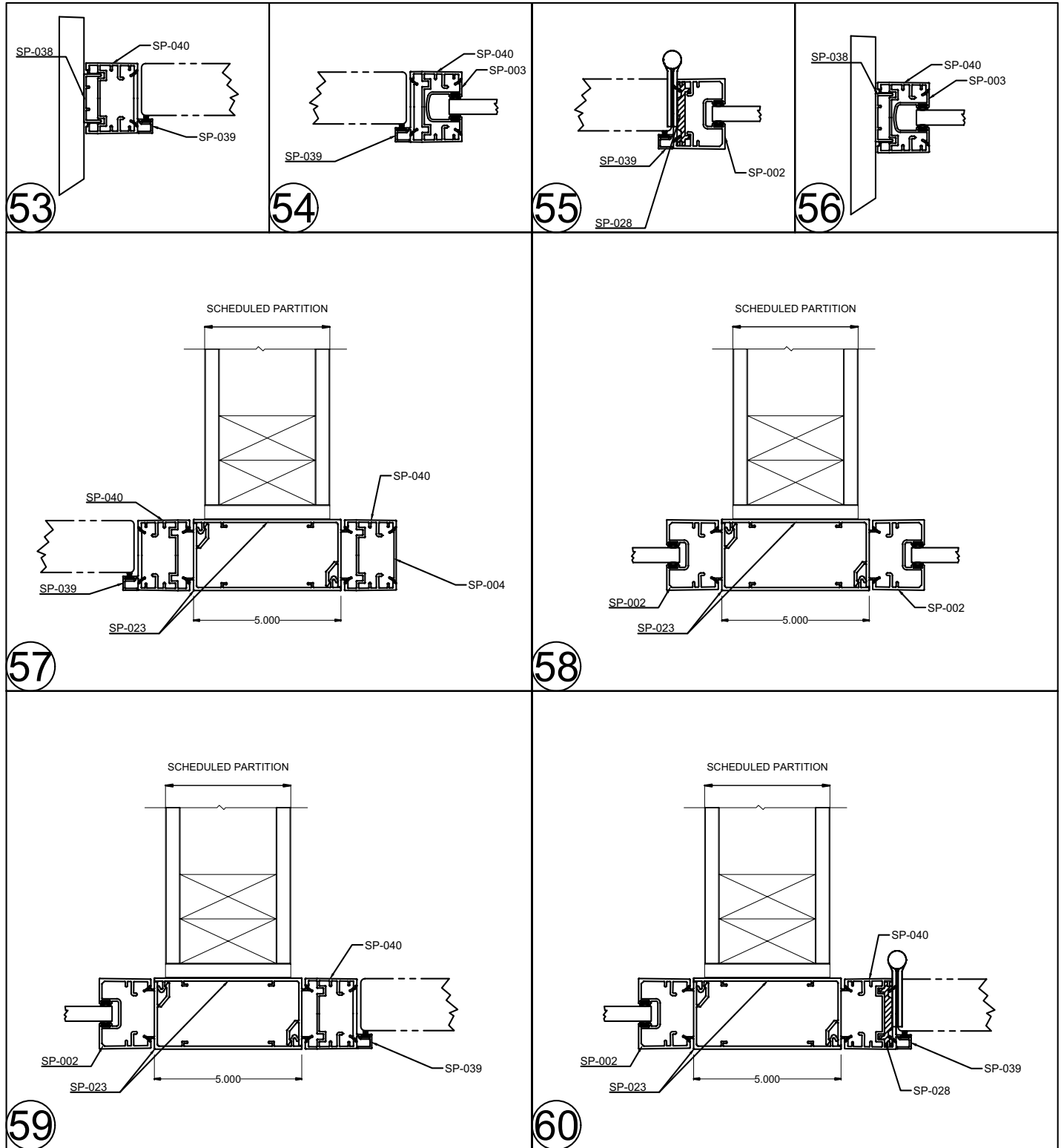

Profile Assemblies

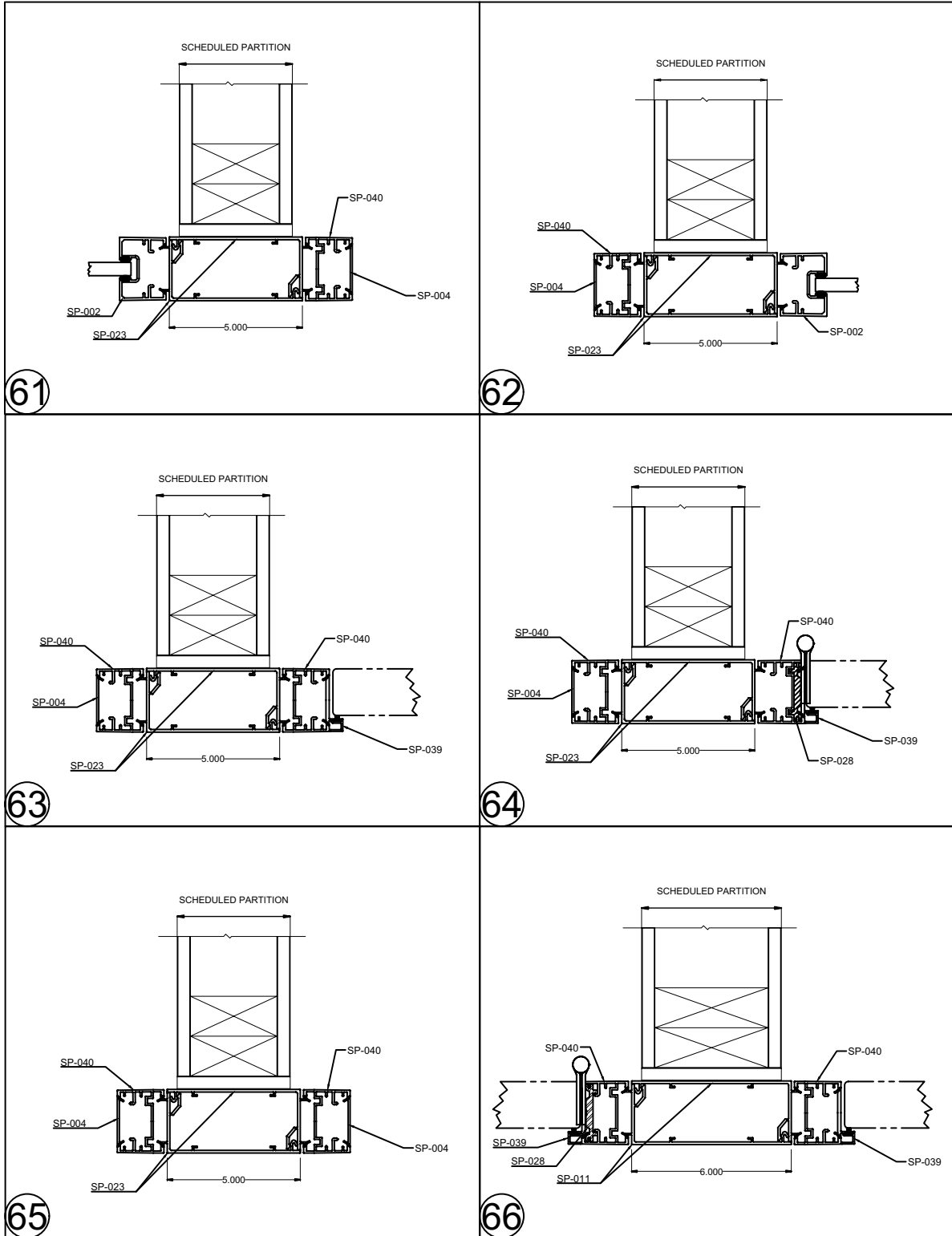

Profile Assemblies

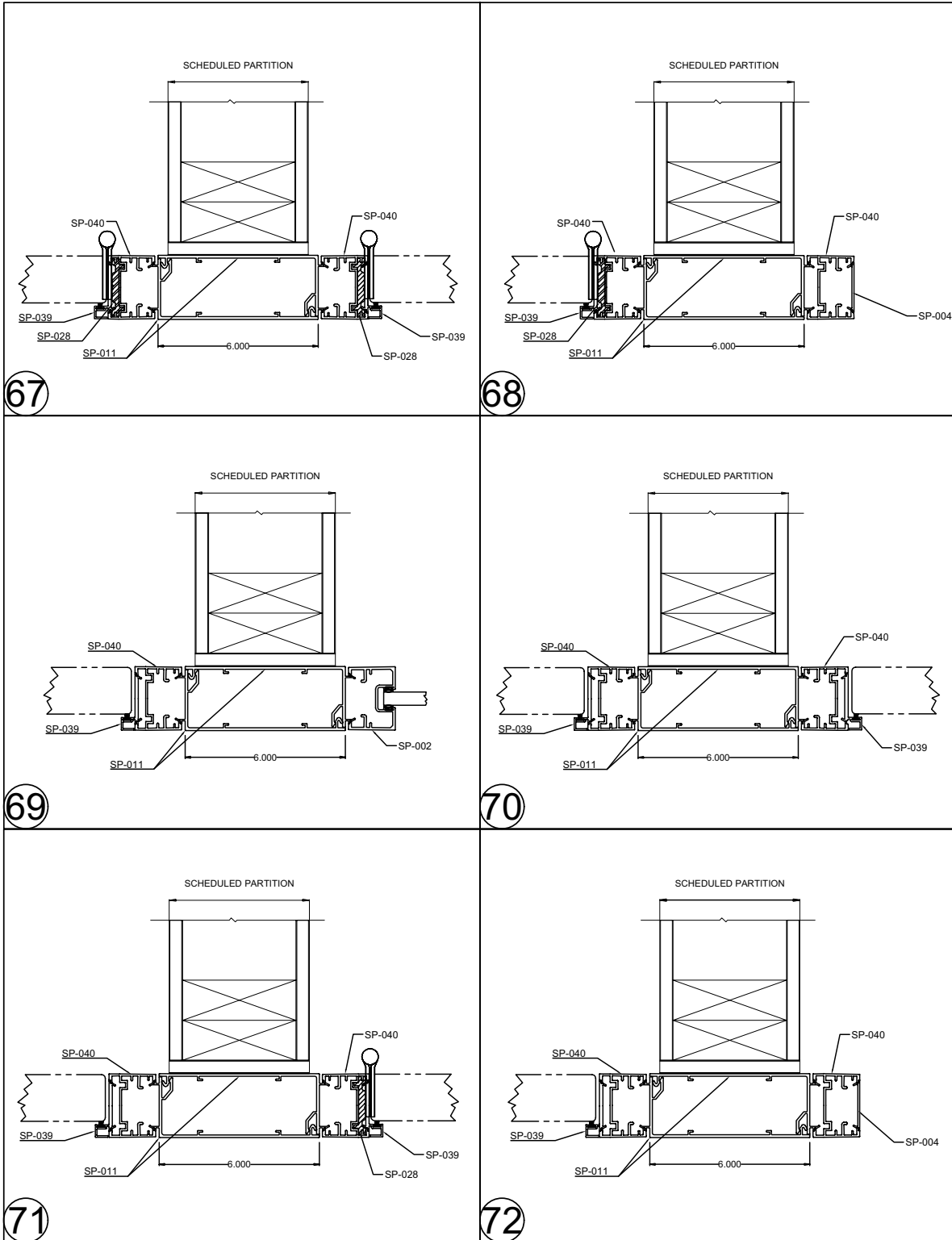

Profile Assemblies

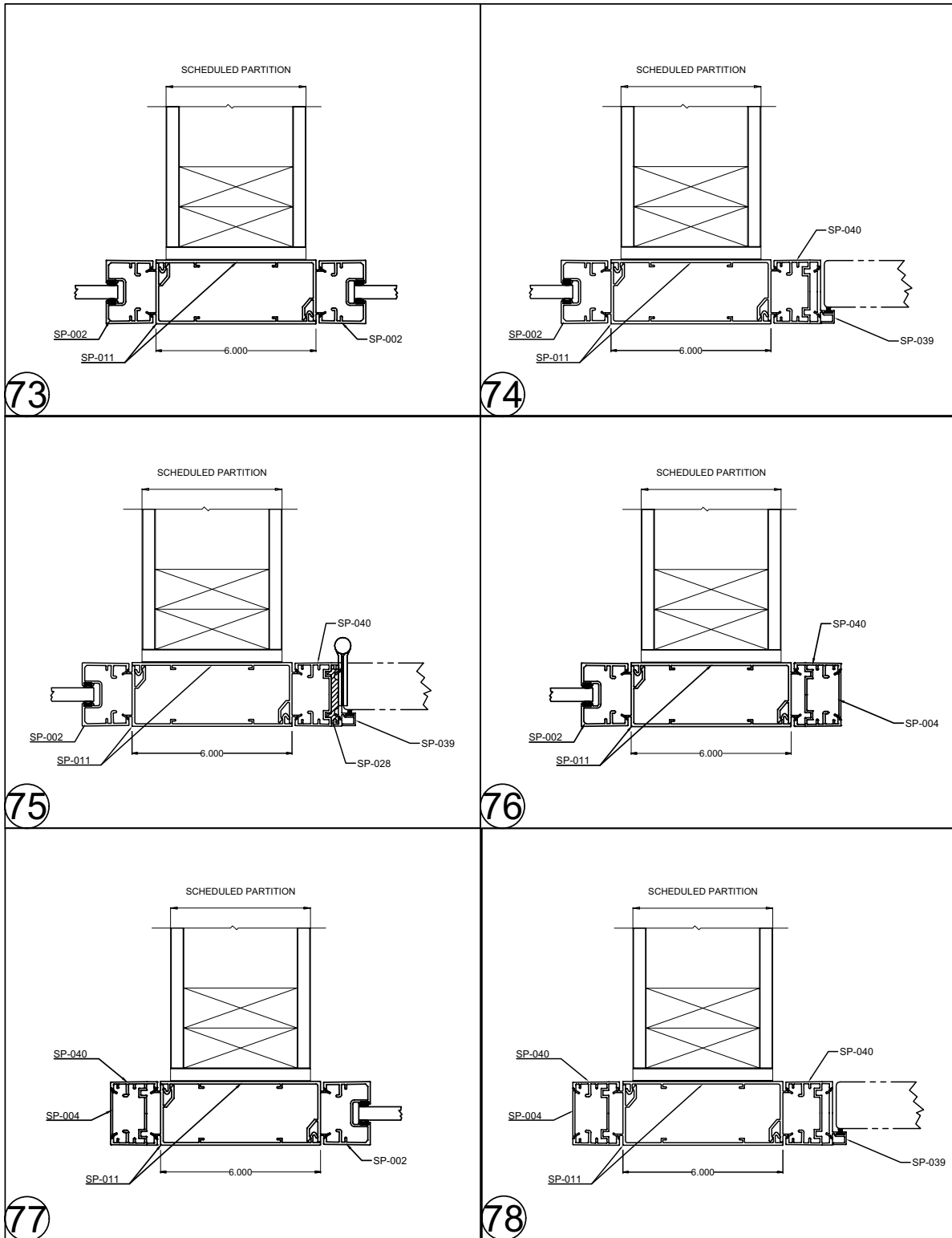

Profile Assemblies

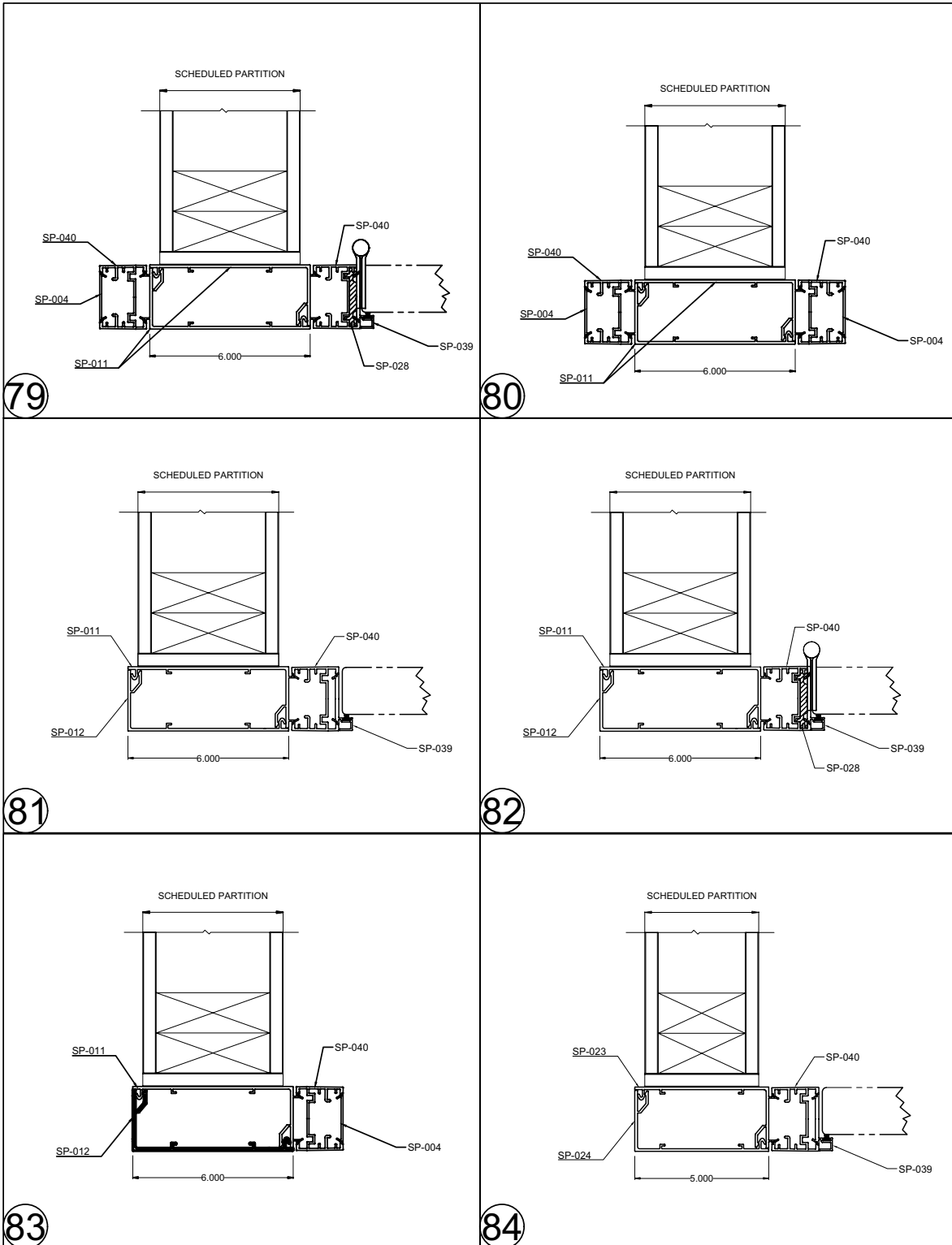

Profile Assemblies

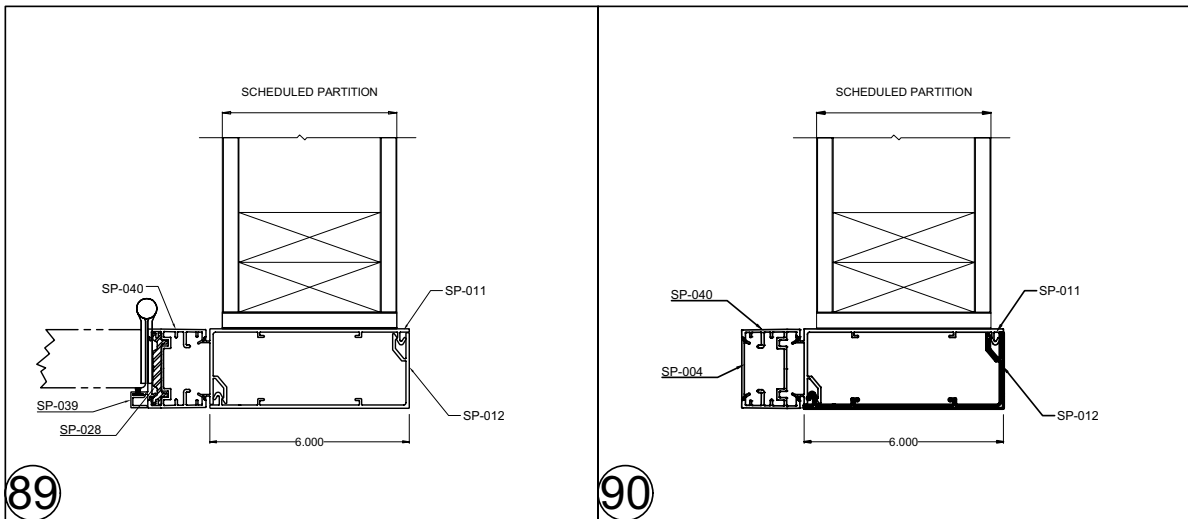
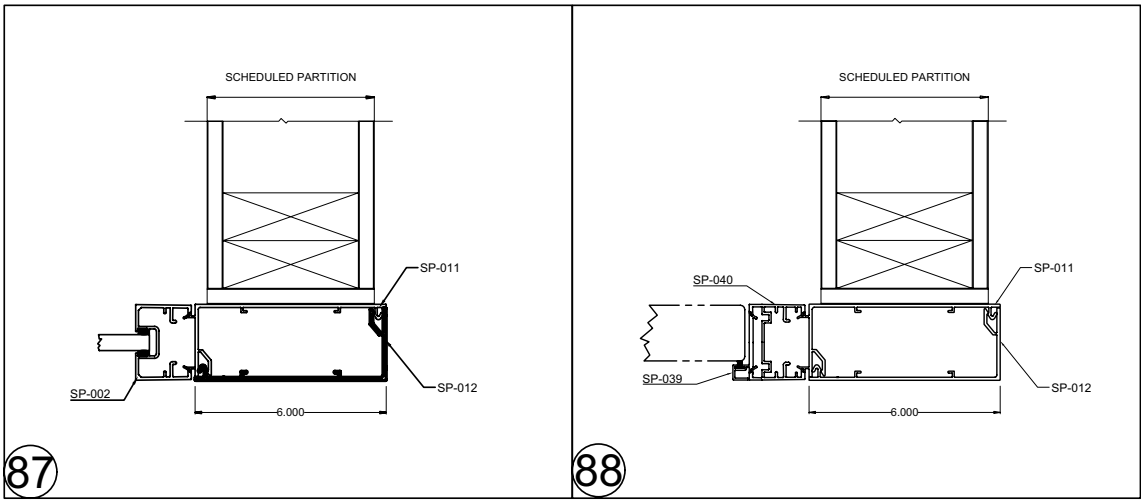
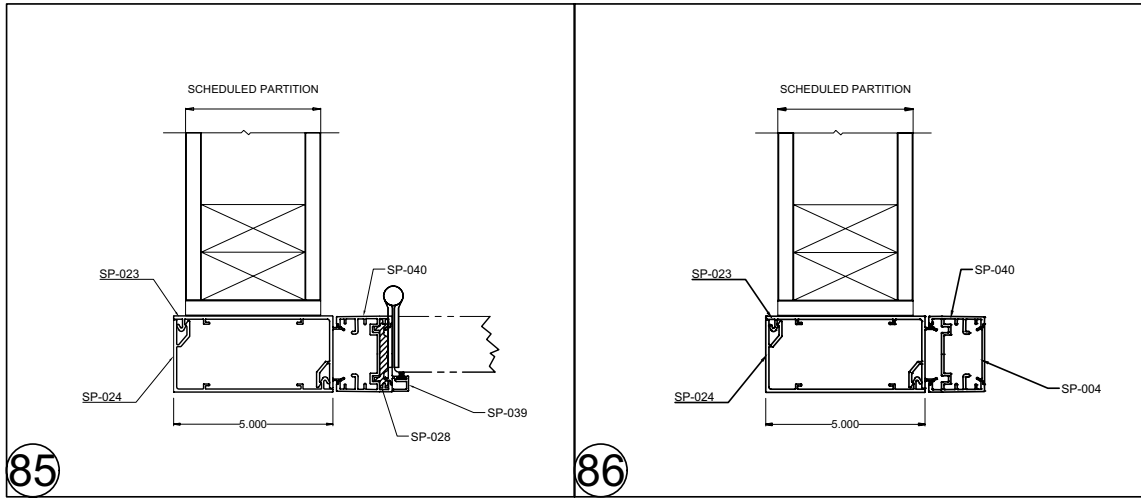

Profile Assemblies

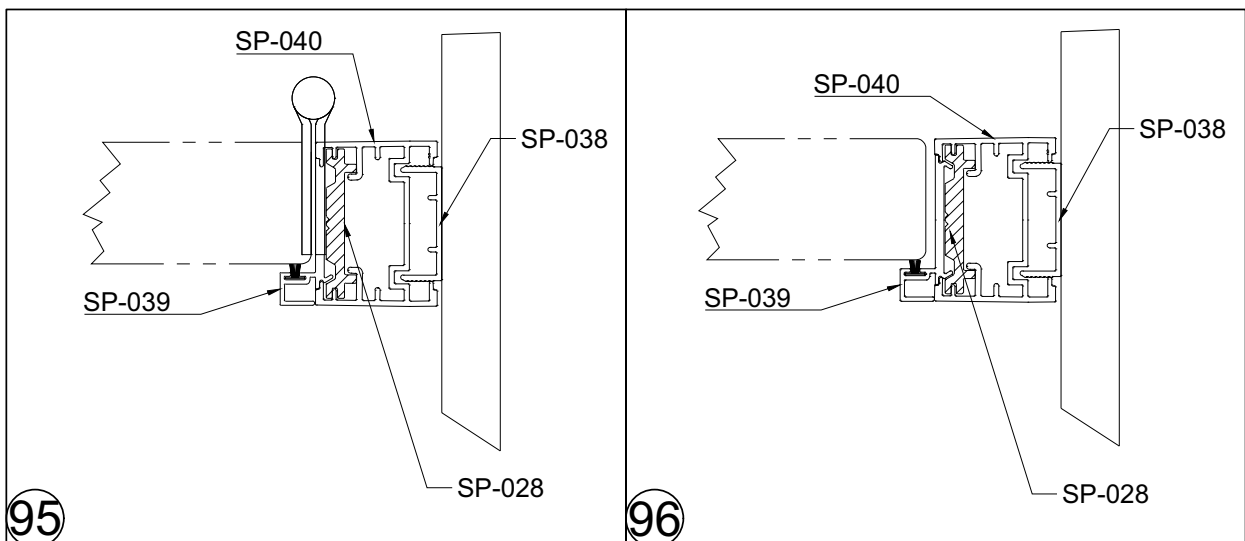
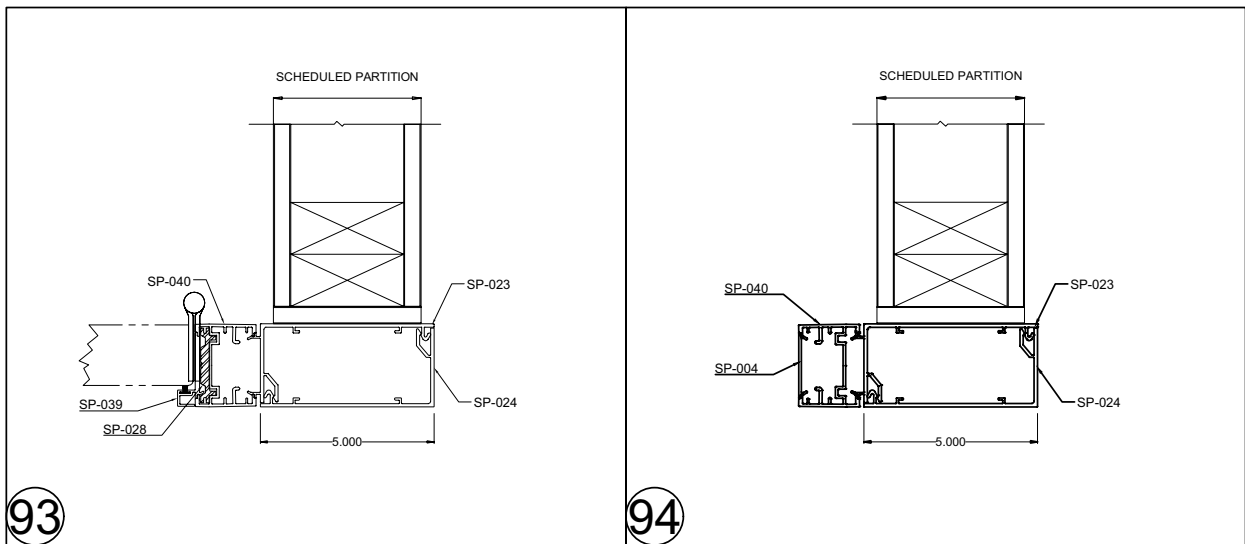
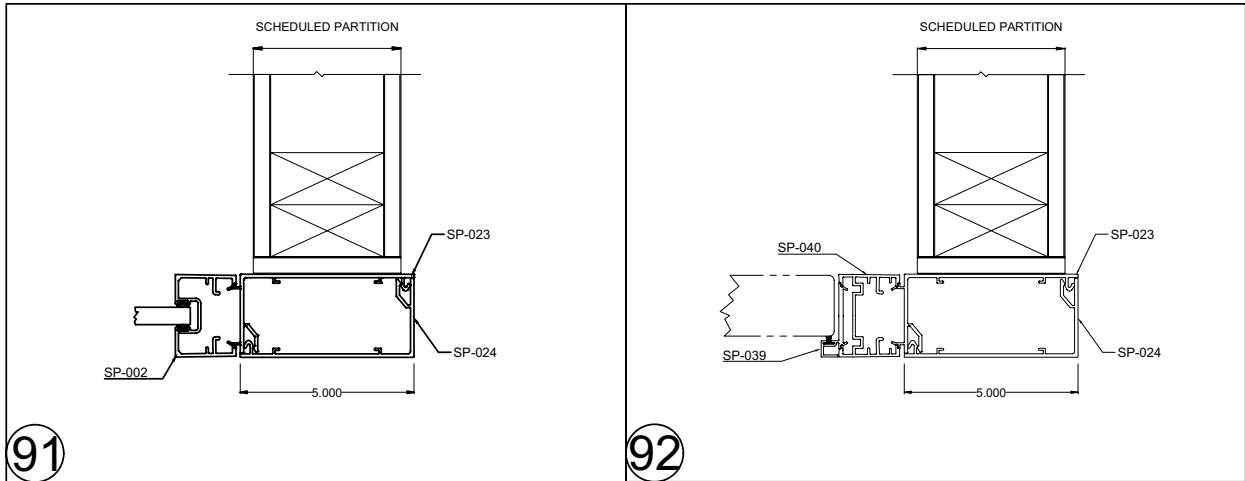

Design & Installation Guide - LiteSpace Interior Aluminum Framing

Template for Sliding Glass Door - Short Track

(as referenced on page 17/How to Measure for Glass)

1

Short Track Sliding Hardware

- Maximum door weight: 120 kg (264 lbs.)
- Glass thickness:
 - Tempered glass: 8, 10, 12, 12.7 mm (5/16" - 1/2")
 - Laminated glass: 8.7 - 12.7 mm (5/16" - 1/2")
 - *Maximum offset: 2 mm (7/32")
- For 1 and 2 sliding glass doors
- For laminated or tempered glass
- Smooth, quiet operation
- Maintenance-free
- Vertical adjustment without removing the glass door
- Low installation height
- Rattle-free bottom guide
- Simple installation

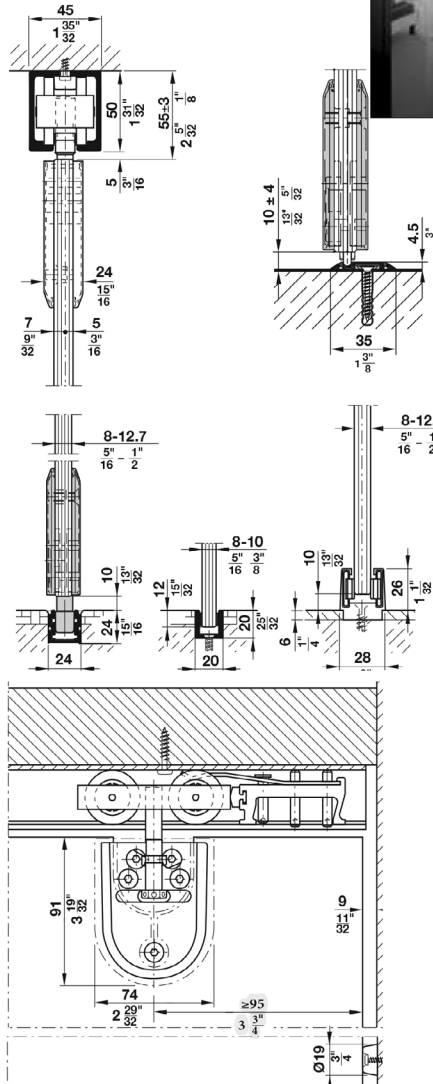
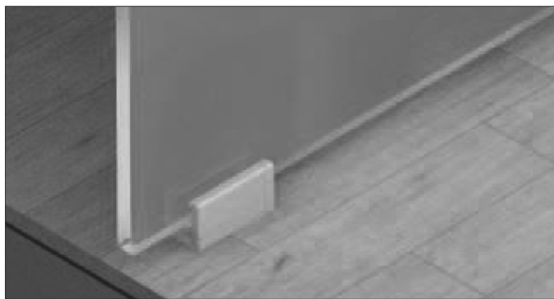
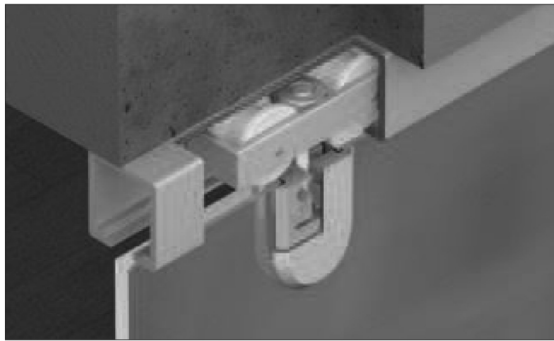

Required Glass Cutouts

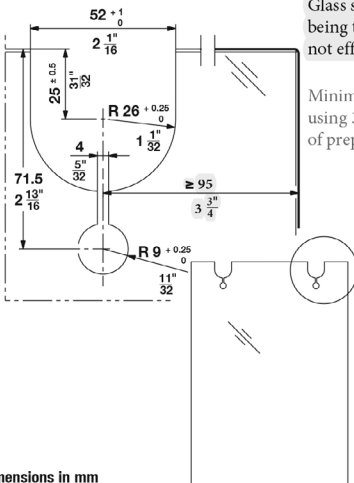

Glass supplier to confirm this cutout being this close to edge of glass will not effect tempering.

Minimum glass door width when using 3-3/4" from edge of glass to CL of prep is 40".

Dimensions in mm
Inches are approximate

Design & Installation Guide - LiteSpace Interior Aluminum Framing

Template for Hydraulic Swing Hardware

8060



3/8" - 1/2"
(10mm) - (12.7mm)



39.37"



MAX 220.5 LBS



+5°F
+104°F



0°-80°

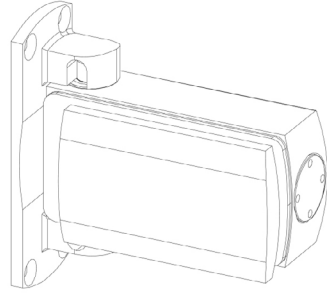

Hydraulic hinge with adjustment of the closing speed glazes of the door with stop. Ideal for hermetic closing. Stop at 0° +90°.

AVAILABLE IN FURTHER TWO VERSIONS: 1) WITHOUT 90° STOP FOR ITEMS 8010 , 8011 AND 8015 - 2) "L" LIGHT WITH WEAKENED SPRING FOR DOORS WITH WIDTH LESS THAN 500MM. Both have to be specified on being ordered and could be subjected to minimum quantity order. For further information, please get in touch with the export department.

Classification according to the law



art. 8060	uNI EN 1154 : 2006	3	8	2	5	0	1	4
-----------	--------------------	---	---	---	---	---	---	---

Tested For 1,000,000 cycles.

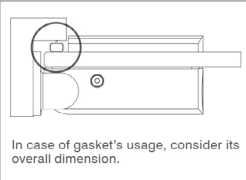

In case of gasket's usage, consider its overall dimension.

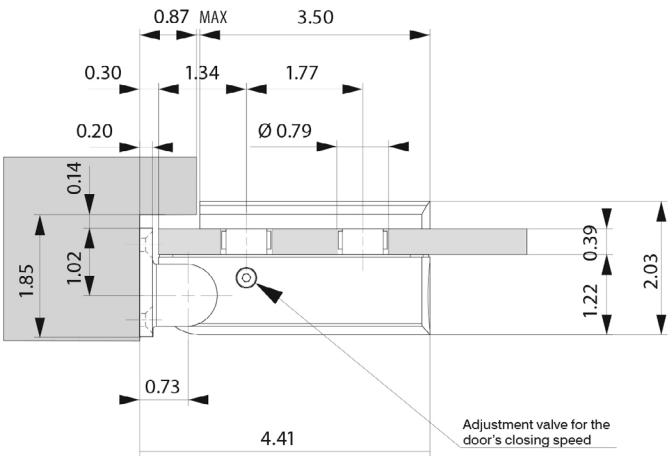

Adjustment valve for the door's closing speed

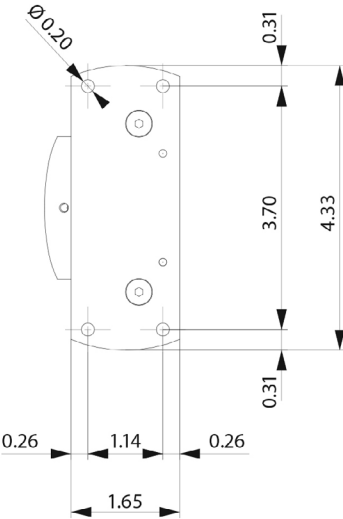

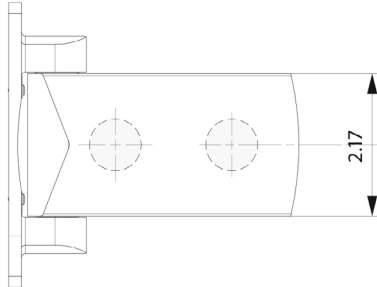

* Minimum distance from wall edge in order to facilitate glass rotation