

# Sliding Door Systems Comparison Guide

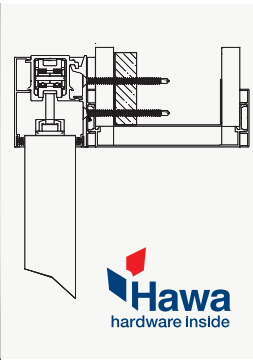

**SpecSlide™**

**Surface-Mounted Sliding Door System**

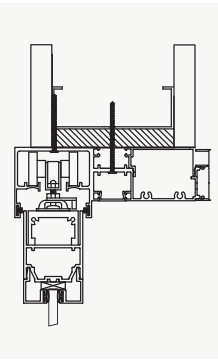

**Omega™**

**Flush-Mounted Sliding Door System**

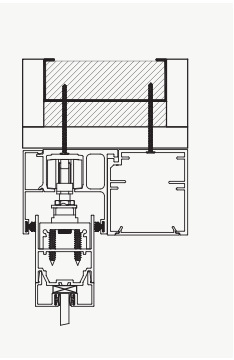

**LiteSpace®**

**Demountable Wall Sliding Door System**

|                                     |  |  |   |
|-------------------------------------|--|--|---|
| <b>Mounting Type</b>                | Surface  | Flush/Inset  | Flush/Inset   |
| <b>Track Profile &amp; Endcaps</b>  | Standard Square Fascia profile, Optional Sloped Fascia profile; Concealed fastener aluminum endcaps.   | Square profile; no endcaps, run track to mullion or full length of the opening.                        | Square profile; Plastic snap-in endcap or run track full length of the opening.                           |
| <b>Fabrication Details</b>          | Factory fabricated to provided dimensions, sliding hardware pre-loaded in track, pre-drilled wall cleat.   | Factory fabricated to provided dimensions.   | Ships in stock lengths, cut to fit at job site.   |
| <b>Packaging Details</b>            | Packaged per opening; Fasteners provided.  | Packaged per opening; Installer provides recommended fasteners.  | Packaged by part; Installer provides recommended fasteners.   |
| <b>Wall Thickness Compatibility</b> | 3-1/2", 3-3/4", 4-7/8", 5-1/4", 5-1/2", 6-1/8", 7-1/4"   | 4-7/8"   | 4-7/8" minimum at head.   |
| <b>Frame &amp; Sidelite Options</b> | Aluminum Cased Opening Frame wraps drywall rough opening, or install directly over a finished opening with no frame. Can be combined with sidelite systems.                      | Omega Type II Aluminum Frame wraps the wall on vertical frame members; Sidelite required.              | LiteSpace features minimal aluminum profiles and installs within finished openings; Sidelite required.    |
| <b>In-Stock Wood Door Options</b>   | Red Oak, White Oak, White Maple<br>(Plain Sliced, Bk & Rn, PC-5, Clear Finish)   |  |   |
| <b>Custom Door Options</b>          | Wood, Aluminum Stile & Rail (single or dual glazed), Aluminum Flush, Hybrid FRP, Composite Fiberglass.*  | Wood, Aluminum Stile & Rail (single or dual glazed), Aluminum Flush, Hybrid FRP, Composite Fiberglass. | Wood, Aluminum Stile & Rail (single or dual glazed), Glass by Glass Supplier (hanging hardware provided). |
| <b>Hardware Packages</b>            | Ladder Pull, Ladder Pull with Deadlock, Locking Ladder Pull (Floor Strike), Mortise Lock with Lever, Auto-Latching Mortise Lock with Lever, Electrified Mortise Lock with Lever. | Ladder Pull, Locking Ladder Pull (Floor Strike).   | Ladder Pull, Locking Ladder Pull (Floor Strike).  |
| <b>Acoustic Options</b>             | Optional Concealed Drop Seal, or Cushioned Close/Open with Concealed Lift & Drop Seal.   |  |   |
| <b>Lead Time**</b>                  | 4 Weeks with Aluminum Stile & Rail Door or In Stock Wood Door; 6-8 Weeks with Custom Door.   | 4 Weeks with Aluminum Stile & Rail Door; 6-8 Weeks with Custom Door.                                   | 4 Weeks with Aluminum Stile & Rail Door; 6-8 Weeks with Custom Door.                                      |

\*Composite Fiberglass Doors are not compatible with Acoustic Options. \*\*Lead times are subject to change. Contact your Special-Lite Representative for current lead times.